

FireAngel[®]

CO-808S User Manual

**Carbon Monoxide
Poisonous Gas
Alarm**

With Sealed 6 Year Power Pack

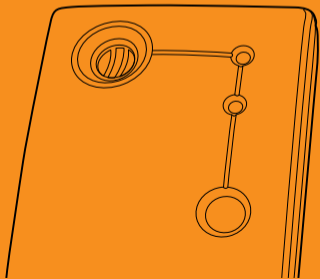

CONTENTS

| | | | |
|---|----|-------------------------------------|----|
| INTRODUCTION | 2 | WHAT TO DO IN THE EVENT OF AN ALARM | 18 |
| FEATURES | 2 | USEFUL NUMBERS | 19 |
| CARBON MONOXIDE AND HOW IT CAN AFFECT YOUR FAMILY | 3 | TECHNICAL INFORMATION | 20 |
| WHERE TO INSTALL YOUR DETECTOR | 6 | DISPOSAL | 21 |
| HOW TO INSTALL YOUR DETECTOR | 9 | 6 YEAR WARRANTY | 22 |
| POWER PACK ACTIVATION | 10 | RETURNS | 23 |
| POWER PACK DEACTIVATION | 11 | PRODUCT RANGE | 24 |
| OPERATING FEATURES | 12 | | |
| Testing the horn, power pack and circuitry | | | |
| Testing the sensor | | | |
| UNDERSTANDING THE PRODUCT'S INDICATORS | 16 | | |
| MAINTAINING/TESTING YOUR DETECTOR | 17 | | |

INTRODUCTION

Congratulations! You've made a wise investment in an innovative product and your personal safety. The FireAngel is one of a new generation of domestic life safety products from FireAngel Limited, which combines the latest technology and innovative design to provide an aesthetically pleasing and effective contribution to your home safety.

The FireAngel range of products is constantly being improved and expanded. Please visit www.fireangel.co.uk to find out about the latest additions to our product range.

FireAngel manufactures one of the most technologically advanced carbon monoxide detectors in the world.

FEATURES

- *An advanced electrochemical sensor designed to accurately measure low levels of carbon monoxide (CO) providing an early warning of toxic CO levels in your home*
- *Detects carbon monoxide continuously*
- *Resistant to false alarms caused by normal household contaminants*
- *Sounds a loud 85dB alarm (at 1 metre (3 feet)) to alert you in case of an emergency*
- *Test/reset button*
- *Simple to mount, portable, ideal for travelling*
- *Independently tested to conform to the British Standards Institute (BSI) Carbon Monoxide Standard BS EN 50291 : 2001*
- *6 year warranty*

CARBON MONOXIDE AND HOW IT CAN AFFECT YOU AND YOUR FAMILY

Carbon monoxide is a dangerous, poisonous gas that kills hundreds of people each year and injures many more. It is often referred to as the silent killer because it has no odour or taste and cannot be seen. Like oxygen, CO enters the body through the lungs during the normal breathing process. It competes with oxygen by replacing it in the red blood cells, thereby reducing the flow of oxygen to the heart, brain and other vital organs. In high concentrations, CO can kill in minutes.

Many cases of reported CARBON MONOXIDE POISONING indicate that while victims are aware they are not feeling well, they become disorientated and unable to save themselves by either exiting the building or calling for assistance. Exposure during sleep is particularly dangerous because the victim usually does not wake up.

Symptoms of CO poisoning

The following symptoms may be related to CO poisoning which all household members should be made aware of:

- **Mild Exposure:** Slight headache, nausea, vomiting, fatigue (often described as 'flu-like' symptoms).
- **Medium Exposure:** Severe throbbing headache, drowsiness, confusion, fast heart rate.
- **Extreme Exposure:** Unconsciousness, convulsions, cardiorespiratory failure, death.

Your FireAngel CO detector monitors the level of CO as parts per million (ppm) in the atmosphere of your property.

35ppm The maximum allowable concentration for continuous exposure for healthy adults in any 8 hour period, as recommended by the Occupational Safety and Health Administration (OSHA).

200ppm Slight headache, fatigue, dizziness, nausea after 2 - 3 hours.

400ppm Frontal headaches within 1 - 2 hours, life threatening after 3 hours.

800ppm Dizziness, nausea and convulsions within 45 minutes. Unconsciousness within 2 hours. Death within 2 - 3 hours.

Should you suspect CO may be affecting you or your family, open the doors and windows of your property to ventilate, turn off your appliances and evacuate the premises. At this time the authorities should be contacted to locate the source of the carbon monoxide before re-entering the building. Medical attention should be sought for anyone suffering the effects of CO poisoning (headache, nausea, see page 3).

Common Sources of CO

- *Oil and gas boilers*
- *Portable generators*

- *Oil or solid fuel cookers*
- *Gas or paraffin heaters*
- *Barbecues*
- *Clogged chimneys*
- *Wood or gas fireplaces*
- *Cigarette smoke*
- *Gas appliances*
- *Any fossil fuel burning appliance*



WARNING: This FireAngel carbon monoxide detector is not a combustible gas detector, nor a smoke detector. Please install the proper detectors to detect combustible gases, or smoke.

This CO detector should not be seen as a substitute for the proper servicing of fuel-burning appliances, nor the sweeping of chimneys.



WARNING: Do not use this carbon monoxide detector on an intermittent basis, or as a portable detector for trying to trace one source of the spillage of combustion products from fuel-burning appliances or from chimneys.

DO NOT

- **IGNORE ANY WARNING FROM YOUR CO DETECTOR!**
- Burn charcoal inside your home, caravan, tent or cabin
- Install, convert or service fuel-burning appliances without proper knowledge, skill and expertise
- Use a gas cooker for heating
- Operate unvented gas burning appliances using paraffin or natural gas in closed rooms
- Operate petrol-powered engines indoors or in confined areas
- Ignore a safety device when it shuts an appliance off
- Use as a portable detector for the spillage of CO from fuel-burning appliances or chimneys

ALWAYS

- Buy appliances accepted by a recognised testing laboratory
- Install appliances according to the manufacturer's instructions
- Have appliance installations carried out by professionals (CORGI registered for gas appliances)
- Have your appliances checked regularly by a qualified service engineer
- Have your chimneys and flues cleaned professionally every year
- Make regular visual inspections of all fuel-burning appliances
- Do not barbecue indoors, or in an attached garage
- Open windows when a fireplace or oil/solid fuel cooker is in use
- Install only CO detectors that meet the requirements of BS EN 50291:2001 in your home
- Be aware of CO poisoning symptoms

EDUCATE YOURSELF AND YOUR FAMILY ON THE SOURCES AND SYMPTOMS OF CO POISONING AND HOW TO USE YOUR CARBON MONOXIDE DETECTOR

WHERE TO INSTALL YOUR DETECTOR



WARNING: This detector will only indicate the presence of carbon monoxide gas at the sensor. Carbon monoxide gas may be present in other areas.

In which room should the detector be installed?

Ideally, an apparatus should be installed in every room containing a fuel burning appliance. Additional apparatus may be installed to ensure that adequate warning is given for occupants in other rooms, by locating apparatus in:

- *Remote rooms in which the occupant(s) spend considerable time whilst awake and from which they may not be able hear an alarm from apparatus in another part of the premises, and*
- *Every sleeping room.*

However, if there is a fuel burning appliance in more than one room and the number of apparatus is limited, the following points should be considered when deciding where best to put the apparatus:

- Locate the apparatus in a room containing a flueless or open-flued appliance, and*
- Locate apparatus in a room where the occupant(s) spend most time.*
- If the domestic premises is a bedsit (a single room serving as both sitting and bedroom) then the apparatus should be put as far from the cooking appliances as possible but near to where the person sleeps.*
- If the appliance is in a room not normally used (for example a boiler room), the apparatus should be put just outside the room so that the alarm may be heard more easily. Alternatively, a remote alarm siren may be connected to a type A apparatus located in a room(s) containing a fuel-burning appliance.*

Where in the room should I place the detector?

Apparatus located in the same room as a fuel-burning appliance:

For both wall and ceiling mounted apparatus the following applies:

- a) The apparatus should be at a horizontal distance of between 1m and 3m from the potential source.*
- b) If there is a partition in a room, the apparatus should be located on the same side of the partition as the potential source.*
- c) Carbon Monoxide alarms in rooms with sloped ceilings should be located at the high side of the room.*

In addition to the above the following must be observed:

If the apparatus is located on a wall:

- a) it should be located close to the ceiling;*
- b) it should be located at a height greater than the height of any door or window;*
- c) it should be at least 150mm from the ceiling.*

If the apparatus is located on the ceiling:

a) it should be at least 300mm from any wall and any ceiling obstruction e.g. light fittings.

Apparatus located in sleeping rooms and in rooms remote from a fuel burning appliance:

Apparatus located in sleeping rooms or located in rooms remote from the fuel-burning appliance should be located relatively close to the breathing zone of the occupants

Where not to put the detector

The apparatus should not be installed:

- In an enclosed space (for example in a cupboard or behind a curtain).*
- Where it can be obstructed (for example by furniture).*
- Directly above a sink*
- Next to a door or window*
- Next to an extractor fan*
- Next to an air vent or other similar ventilation openings*

- In an area where the temperature may drop below -10°C or exceed 40°C*
- Where dirt and dust may block the sensor*
- In a damp or humid location (for example in a bathroom)*
- In the immediate vicinity of the cooking appliance*

HOW TO INSTALL YOUR DETECTOR



NOTE: This Carbon Monoxide detector must be installed by a competent person.

Firstly write the installation date on the back of your alarm in the designated box.

We recommend that your detector is installed on the wall.

To Mount on a Wall or Ceiling:

Use the backing plate to mark the position of the drill holes.

Drill 5mm (3/16") holes into the wall. Insert the plastic wall plugs. Place backing plate over drilled holes and screw in the screws. Ensure screws are fully tightened to allow detector to be mounted.

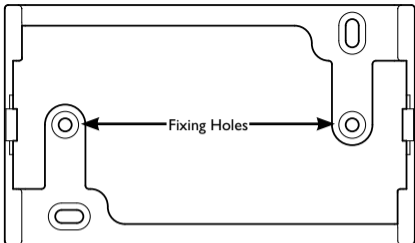

To Mount on a Shelf:

The detector has a flat base allowing it to simply stand on a shelf. The backing plate is not required for this application.



WARNING: When mounting on a shelf, please adhere to same positional recommendations as described on page 7 and 8.

NOTE: Your detector can be removed from the backing plate by following the instructions on page 14.

POWER PACK ACTIVATION

See diagram opposite

- a. Your detector comes complete with an integrated power pack that will power your detector for its entire operational life. To activate the power pack you need to pull the disabling tab (see image). This will in turn pull out the disabling clip, which is attached to the end of the ribbon, from the disabling plug which is situated on the underside of the detector. Retain the disabling tab by taping it inside the cover of this manual.
- b. When the detector is activated both LEDs will flash and the detector will chirp momentarily.
- c. Your advanced FireAngel detector requires a short warm up period before it is fully operational. If you have followed all of the above steps correctly, your unit will begin monitoring for CO in around 3 minutes. When the 3 minute warm-up period is complete, the green power LED will flash once per minute to indicate that the detector is receiving power from the power pack and is fully operational (if your detector chirps or enters

alarm following the 3 minute warm-up period then please refer to page 16 - Understanding the Product's Indicators).

- d. Test the horn, power pack and circuitry by pressing the Test/Reset button to confirm that the

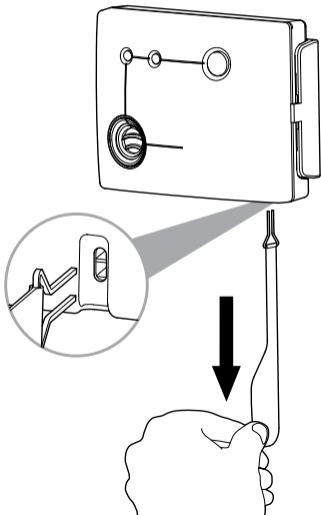

detector is operating properly. The horn should sound as soon as the button is pressed, and the LEDs will flash indicating that the horn is working and the power pack is providing power to the unit. This test for the horn, power pack and circuitry should be performed on a weekly basis.

 **WARNING:** Prolonged exposure to the horn in close proximity to your ears will damage your hearing.

Under normal operating conditions, the power pack will last for the lifetime of the product i.e. 6 years.

The detector will not protect against the risk of carbon monoxide poisoning when the power pack has drained.

 **WARNING:** Constant exposure to extreme high or low temperatures may reduce the life of the power pack.

POWER PACK DEACTIVATION

Your CO-808S is portable, making it ideal for taking with you on holiday. You will need to deactivate your detector when travelling or even when storing i.e. when decorating. Fitting is the reverse of removal. To deactivate the detector the two ends of the metal clip must be inserted into the corresponding holes in the disabling plug located on the underside of the detector (see image). You can ensure that the product is disabled by pressing the test button - if there is no sound from the sounder then the clip has been fitted correctly.

The clip must remain in the disabling plug to keep the power pack deactivated.

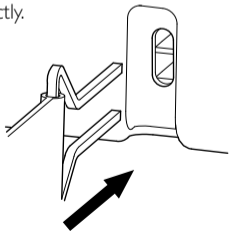

OPERATING FEATURES

Your FireAngel detector offers many features which set it apart from other CO detectors on the market today.

TEST/RESET BUTTON FEATURE

This button will:

- Test your horn, power pack and circuitry
- Allows you to test the sensor by introducing a source of CO into the detector (see page 13).
- Silence the loud 85dB (at 1 metre (3 feet)) horn during an alarm (only for alarms due to levels of CO of less than 50ppm)

Testing the Horn, Power Pack and Circuitry

Test the horn, power pack and circuitry by pressing the Test/Reset button briefly to confirm that the detector is operating properly. The horn should sound as soon as the button is pressed,

and both the LEDs will flash indicating that the horn is working and the power pack is providing power to the unit. This test for the horn, battery

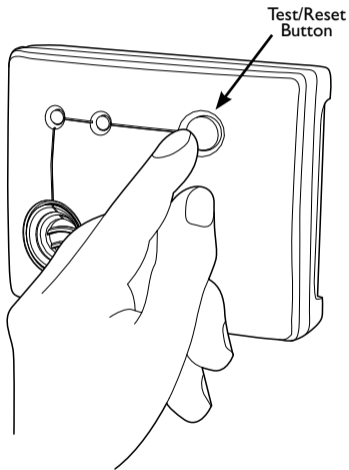

and circuitry should be performed on a weekly basis.

Testing The Sensor



NOTE: We suggest the use of an incense stick or cigarette as the inefficient way in which these products burn means the smoke given off contains a detectable localised amount of carbon monoxide. Alternative sources of smoke, for example an extinguished candle or match, will not contain sufficient levels of carbon monoxide to obtain a response from the alarm during this test. Please note your CO alarm will not detect smoke.

If testing for the first time after installation, or reactivating the power pack by removing the disabling ribbon following a period of deactivation, make sure that the detector has completed the initial 3 minute warm up period and the green power LED is flashing once every minute.



CAUTION: Sensor testing should only be performed by a responsible adult.

This test should only be performed once a month. Excessive testing will cause the life of the power pack to be shortened.



NOTE: CO test kits may be used in order to avoid having to burn cigarettes, incense sticks etc. However we recommend that incense sticks are used as they are readily available.

- Read **all** steps thoroughly before attempting to test your the sensor

Step 1 If the detector is wall or ceiling mounted use a flat head screwdriver to lever the detector away from the backing plate (see page 14).

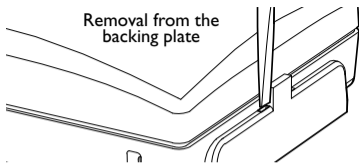

Step 2 Cover the sounder vent with your left thumb/finger. Press and hold the Test/Reset button down with your right thumb/finger until the green power LED stops flashing and only the red alarm LED flashes once per second (this should happen after around 5 seconds). Release the Test/Reset button. Upon releasing the Test/Reset button the green power LED will begin to flash twice in quick succession every 5 seconds. This indicates that the detector is now monitoring for CO every second and may be tested using a known source of CO.

Step 3 Light a cigarette or an incense stick using a match or lighter. If using an incense stick

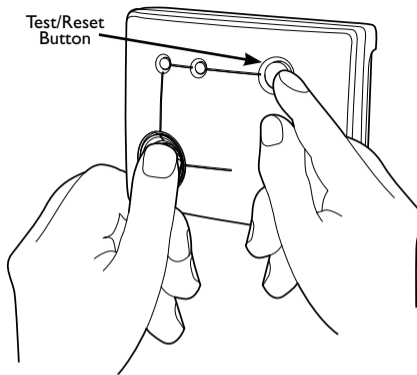

be sure to blow out the flame so that the incense stick is smouldering. Extinguish the lighter, or put out the match and place it into a dish of water.

Step 4 Turn the alarm on its side so that the vents nearest the Test/Reset button on the side of the alarm are pointing downward

(see diagram below). Hold the burning cigarette or incense stick 15 - 20 cm (6 - 8 inches) below the detector, so that the smoke enters the vents on the side of the detector. An increase in the localised carbon

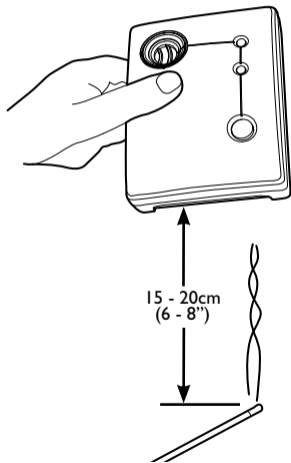

monoxide level within the sensor to more than 100ppm will cause the horn to sound momentarily and the green power LED to illuminate continuously for a short time and then flash rapidly. (**Note** - It may take up to 3 minutes of exposure to the smoke for the localised level of carbon monoxide within the sensor to reach over 100 ppm. In addition please note that the full alarm will only sound if excessive amounts of CO are detected during this short test). Now move the source of CO away from the detector as the test is finished.

Step 5 After step 4, put out the incense stick or cigarette by placing it into a dish of water. Ensure that all flames have been extinguished. As the level of CO falls the green power LED will stop flashing and will again continuously illuminate for a short time. The unit will then return to sensor test mode with the green power LED flashing twice every 5 seconds.

Step 6 *After around four minutes the detector will return to normal monitoring mode and the green LED will flash once per minute.*

UNDERSTANDING THE PRODUCT'S INDICATORS

The higher the concentration of carbon monoxide detected by the alarm, the quicker it will respond. When sufficient carbon monoxide is detected a loud audible signal (85 dB at 1m (3 feet)) will be emitted and the red alarm LED will flash 4 times every second.

The Alarm will sound:

- *When concentrations of CO of more than 30ppm but not more than 50ppm have been detected for more than 2 hours.*
- *Between 60 and 90 minutes when exposed to a minimum of 50ppm of CO.*
- *Between 10 and 40 minutes when exposed to a minimum of 100ppm of CO.*
- *Within 3 minutes when exposed to a minimum of 300ppm of CO.*

Error Signal:

The unit continuously checks the settings of its sensor and circuitry. If any of these settings are found to be incorrect the unit will emit a **double** chirp every minute, indicating that a product fault has been identified.

NOTE: This does **NOT** mean that the alarm has detected carbon monoxide.

Low Power Pack Signal:

At the end of the product's life, it will emit a single chirp once per minute for up to 30 days.

Replace the product immediately! If a low power pack warning is emitted before 6 years of operation contact the FireAngel Technical Support team (see below).

On discovering an error signal please contact the FireAngel Technical Support Line between 9.00am – 5.00pm, Monday – Friday.

Telephone: 024 7623 6663 (1-800 523171 in Eire) e-mail: technicalsupport@fireangel.co.uk

MAINTAINING / TESTING YOUR DETECTOR

Maintenance

Your detector will alert you to potentially hazardous CO concentrations in your home when maintained properly. To maintain your FireAngel detector in proper working order, and to ensure that the sensor will last for the lifetime of the product, it is recommended that you:

- *Test the horn, power pack and circuitry of your detector at least once per week by pressing the Test/Reset button briefly (see page 12).*
- *Perform the Sensor Test once every month (see page 13).*
- *Keep the detector free of dust by gently vacuuming the case with a soft brush attachment once per month.*

To prevent the possibility of contaminating the sensor in your alarm and thus affecting its reliability:

- Never use cleaning solutions on your detector. Simply wipe with a slightly damp cloth.
- Do not paint the detector.
- Do not spray aerosols on or near the detector.
- Do not use any solvent based products near the detector.
- Move the detector to a safe location and store in a plastic bag before painting, wall papering, or performing any other activities using materials that emit strong fumes. Remember to remove it from the bag and replace the detector when these activities are finished.

Failure of any test should be reported to the technical support line (see page 17 for contact details).

WHAT TO DO IN THE EVENT OF AN ALARM



WARNING: A loud alarm is a warning that unusually high and potentially lethal levels of carbon monoxide are present. Never ignore this alarm, further exposure can be fatal. Immediately check residents for symptoms of carbon monoxide poisoning, and contact the proper authorities to resolve all CO problems. **NEVER IGNORE ANY ALARM.**

Please carefully review this owner's manual to ensure that you know what actions to take in the event of an alarm.

What To Do During An Alarm

- *Keep calm and open the doors and windows to ventilate the property.*
- *Turn off the appliance where possible and stop using the appliance.*

- *Evacuate the property leaving the doors and windows open.*
- *Ring your gas or other fuel supplier on their emergency number; keep the number in a prominent place.*

Write your fuel supplier's emergency number here (see opposite for more useful numbers):

- *Do not re-enter the property until the alarm has stopped.*
- *Get medical help immediately for anyone suffering the effects of carbon monoxide poisoning (headache, nausea), and advise that carbon monoxide poisoning is suspected.*
- *Do not use the appliance again until it has been checked by an expert. In the case of gas appliances this must be a CORGI registered installer.*

USEFUL NUMBERS

National Gas Emergency Service -
0800 111 999 (24hours)

CORGI - **0800 915 0485**

Solid Fuel Association (Advisory service for domestic solid fuel appliances) - **0845 601 4406**

HETAS (Trade association for solid fuel engineers) - **0845 223 3033**

OFTEC (Trade association for Oil Fired Appliance engineers) - **0845 658 5080**

NACS (National Association of Chimney Sweeps) - **0800 833 464**

IPHE (Institute of Plumbing and Heating Engineers) - **0870 414 5533**

TECHNICAL INFORMATION

| | |
|----------------------------------|-------------------------------------|
| Detector Specifications: | <i>Model CO-808S</i> |
| Sensor Type: | <i>Electrochemical</i> |
| Sensor Life: | <i>6 Years</i> |
| Alarm Sound Level: | <i>85dB (at 1 metre (3 feet))</i> |
| Power Pack Life: | <i>6 years (Life of product)</i> |
| Temperature Range: | <i>-10°C (14°F) to 40°C (104°F)</i> |
| Operating Humidity Range: | <i>30 - 90% RH</i> |
| Weight: | <i>185 grams (6.5oz)</i> |
| Certified to: | <i>BS EN 50291 : 2001</i> |

The FireAngel carbon monoxide detector is designed to continuously monitor for CO. Its response times meet the requirements of BSI standard BS EN 50291 : 2001.

The alarm will sound:

- *When concentrations of CO of more than 30ppm but not more than 50ppm have been detected for more than 2 hours.*
- *Between 60 and 90 minutes when exposed to 50ppm of CO.*
- *Between 10 and 40 minutes when exposed to 100ppm of CO.*
- *Within 3 minutes when exposed to CO levels of 300ppm or more.*

**WARNING:**

APPARATUS

CONFORMING TO THIS STANDARD
MAY NOT PROTECT PEOPLE WHO ARE AT
SPECIAL RISK FROM CARBON MONOXIDE
EXPOSURE BY REASON OF AGE,
PREGNANCY OR MEDICAL CONDITION.
IF IN DOUBT, CONSULT YOUR DOCTOR.

A CARBON MONOXIDE DETECTOR IS NOT
A SUBSTITUTE FOR A SMOKE ALARM OR A
COMBUSTIBLE GAS DETECTOR.

REPLACE UNIT AFTER **6 YEARS** OF
OPERATION.

Quick Reference Label

A Quick Reference label is located on the back
of your detector and provides you with general
instructions on the actions to take when your
alarm sounds. For full details, read this owner's
manual carefully.

DISPOSAL

Waste electrical products should not be disposed
of with regular household waste. Please recycle
where facilities exist. Check with your local
authority, retailer or manufacturer for recycling/
disposal advice as regional variations apply.

The power pack should be deactivated before
disposal. To do this, insert the pins on the end of
the disabling ribbon back in to the socket on the
underside of the alarm. You can also return your
carbon monoxide alarm to us for disposal. For
return address see the section on Returns. Please
include a note confirming the product is being
returned for disposal.



WARNING: DO NOT ATTEMPT
TO OPEN - DO NOT BURN



6 YEAR WARRANTY

Warranty Coverage

FireAngel Ltd warrants to the original purchaser that its enclosed sealed carbon monoxide alarm be free from defects in materials and workmanship under normal residential use and service for a period of 6(six) years from the date of purchase.

Provided it is returned with postage prepaid and proof of purchase date, FireAngel Ltd hereby warrants that during the 6(six) year period commencing from the date of purchase FireAngel Ltd, at its discretion, agrees to replace the unit free of charge. The warranty on any replacement FireAngel CO-808S Sealed Carbon Monoxide Alarm, will last for the remainder of the period of the original warranty in respect of the alarm originally purchased – that is from the date of original purchase and not from the date of receipt of the replacement product. FireAngel Ltd reserves the right to offer an alternative product similar to that being replaced if the original model is no

longer available or in stock. This warranty applies to the original retail purchaser from the date of original retail purchase and is not transferable.

Proof of purchase is required.

Warranty Disclaimers

This warranty does not cover damage resulting from accident, misuse, disassembly, abuse or lack of reasonable care of the product, or applications not in accordance with the user manual. It does not cover events and conditions outside of FireAngel Ltd's control, such as Acts of God (fire, severe weather etc). It does not apply to retail stores, service centres or any distributors or agents. FireAngel Ltd will not recognise any changes to this warranty by third parties. FireAngel Ltd shall not be liable for any incidental or consequential damages caused by the breach of any expressed or implied warranty. Except to the extent prohibited by applicable law, any implied warranty of merchantability or fitness for a particular purpose is limited in duration to 6 years.

This warranty does not affect your statutory rights. Except for death or personal injury, FireAngel Ltd shall not be liable for any loss of use, damage, cost or expense relating to this product or for any indirect, or consequential loss, damages or costs incurred by you or any other user of this product.

RETURNS

Warranty Coverage

We recommend that you contact the FireAngel Technical Support Line in the first instance on **024 7623 6663** (1-800 523171 in Eire) Monday-Friday 9am to 5pm or via e-mail: **technicalsupport@fireangel.co.uk** as we may be able to remedy the problem quickly over the phone (this is to prevent unnecessary returns that take a longer time to process). Please quote the product model number CO-808S. If there is a fault that we are unable to resolve then our technical support engineer will issue you with a returns authority number so that your product can be returned for testing.

To return your FireAngel under warranty, send it suitably packed and disabled (this will be explained by the FireAngel technical support engineer) with postage prepaid; a note indicating the returns authority number and describing the nature of the difficulty, with proof of purchase to:

FireAngel Limited
The TechnoCentre
Puma Way
Coventry CV1 2TT
UK

PRODUCT RANGE

FireAngel Ltd manufactures an extensive range of home safety products including smoke alarms, carbon monoxide alarms, fire extinguishers and remote sounding devices. For more details visit www.fireangel.co.uk.



Independently tested to conform to BS EN 50291:2001

FireAngel[®]

Technical Support Line

024 7623 6663 (1-800 523 171 in Eire)

E-mail:

technicalsupport@fireangel.co.uk

Web:

www.fireangel.co.uk