

FP1640W2-R Troubleshooting Guide

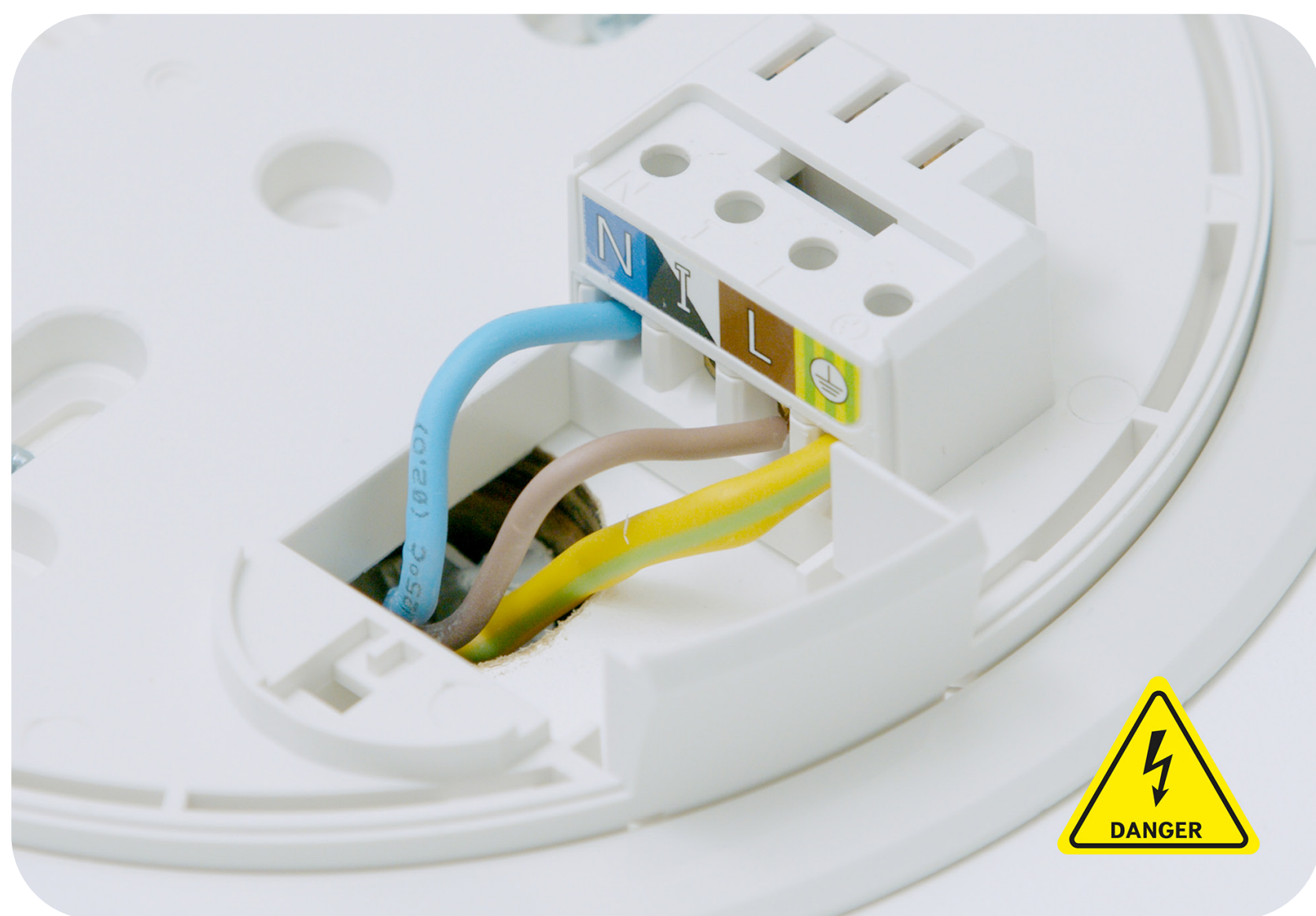

An electrician is required to fit this product into your homes' 230V mains electrical circuit.

1st Fix

An electrician is required to fit the base plate for this product into your homes' 230V mains electrical circuit.

2nd Fix

Add the device head to the base plate once you have completed any renovations or decorating.

Please note: the FP1640W2-R will only interlink with other alarms in the FireAngel Pro Connected range.

Incorrectly attached to baseplate

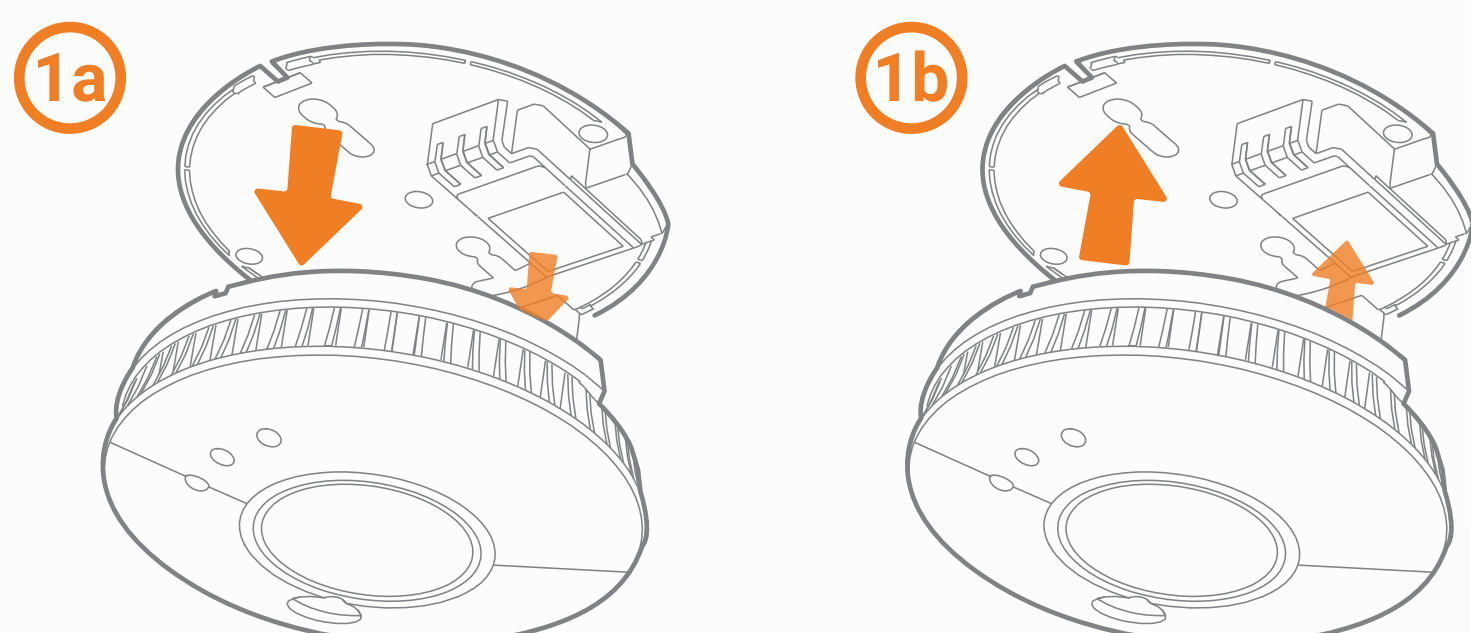

Incorrect wireless connection

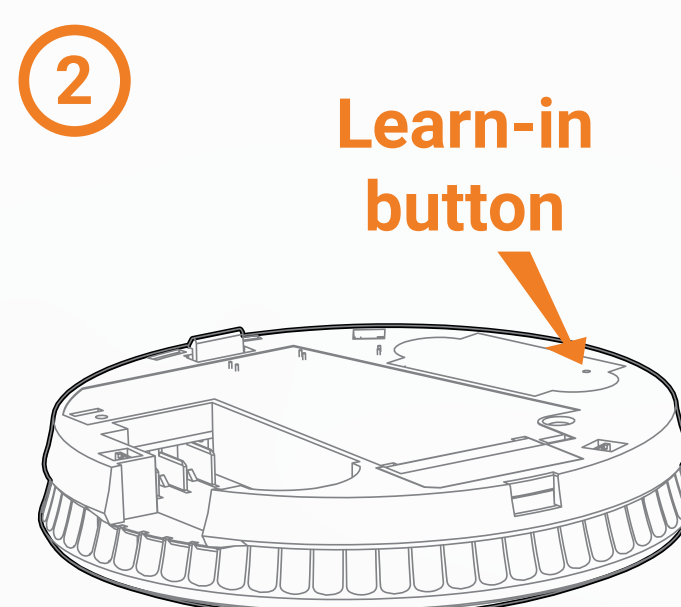

Using a ballpoint pen in the 'learn-in' hole in the back of the alarm, briefly push and release and then push and hold the 'learn-in' button.

The red LED will remain illuminated during this process. When the red LED goes out, release the button, it will then flash twice, followed by three further flashes to illustrate that the alarm has successfully been 'un-learned' from the network.

Clean and dust each alarm

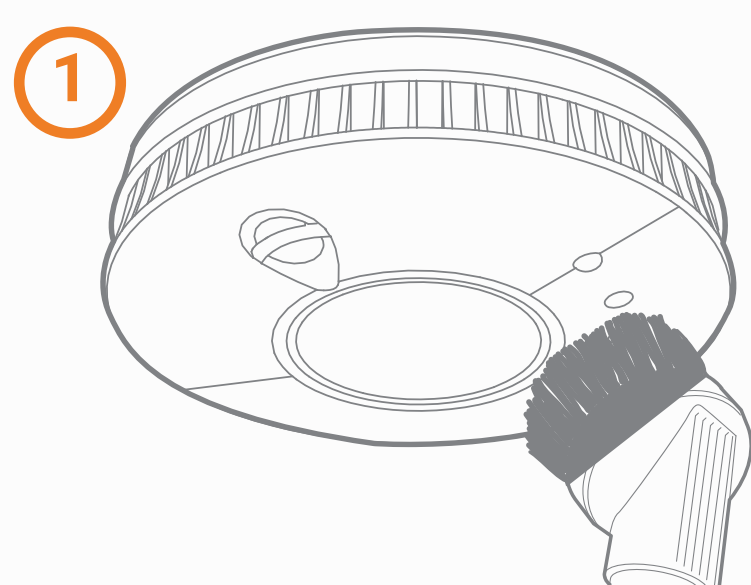

'Unlearn' each alarm in the network and refit

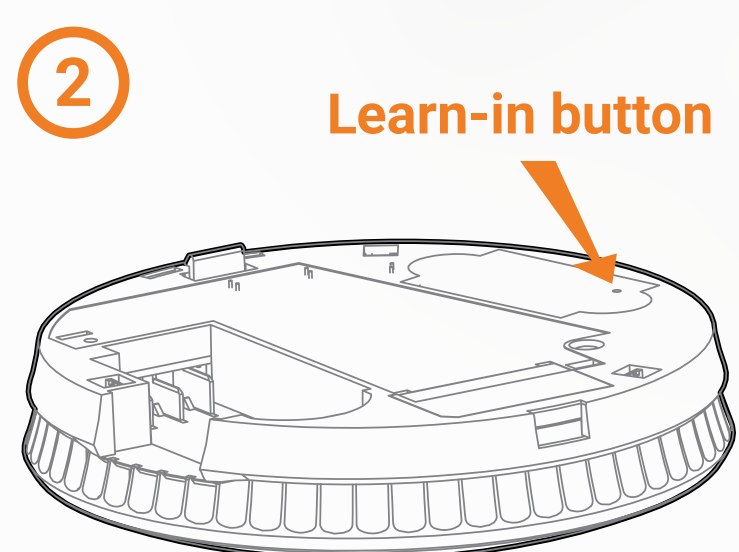

Remove alarm with red LED flashing rapidly.

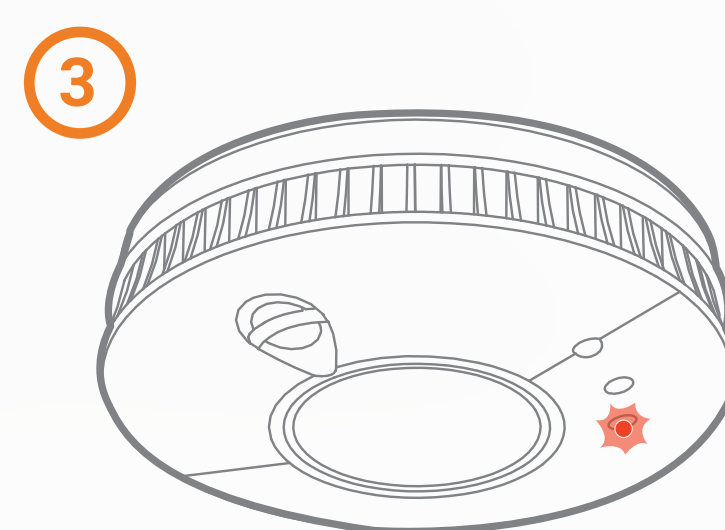

Seek replacement or contact support

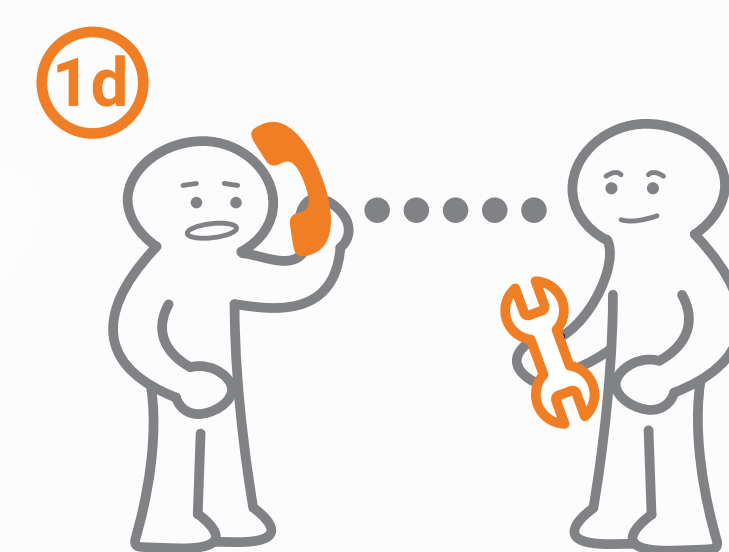

Detach alarm from base and reattach

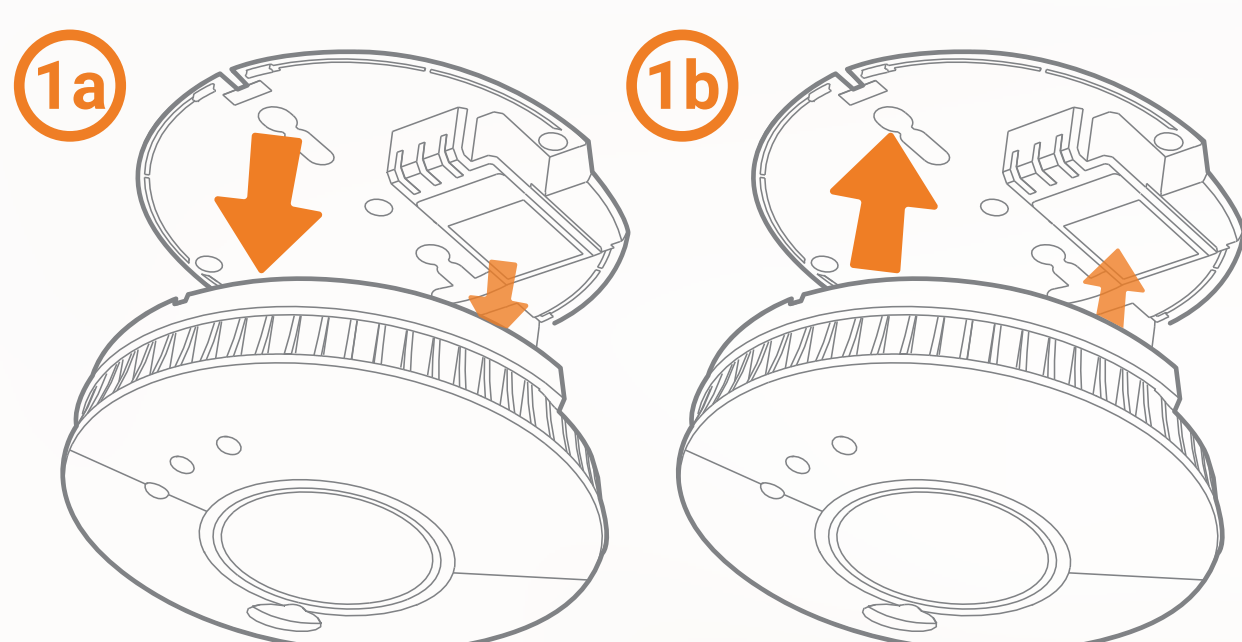

Test your alarm twice



Seek replacement or contact support

