

FA6611, FA6615 & FA6620 OPTICAL SMOKE ALARM & FA6720 HEAT ALARM - USER MANUAL

Optical smoke alarms FA6611, FA6615 and FA6620 are suitable for detecting slow smouldering fires. Like other smoke alarms, they can be subject to nuisance alarms from steam and should not be placed near bathrooms.

For the earliest warning, we recommend smoke and heat alarms are fitted in all rooms where the temperature is between 4°C and 38°C. Prolonged exposure to temperatures outside those stated above will reduce product life.

Heat alarm FA6720 is specified for Class A1 detection. Your heat alarm will sound a warning when the ambient temperature in a room is between 54°C and 65°C. For the best protection, heat alarms should always be installed as part of a complete fire protection system that includes smoke alarms.

Check with local building and fire regulations for your property, to ensure compliance.

WARNING: Experience has shown that children may not be woken by fire alarm tones. It is important that children are never left alone in a house. Families should have a fire escape plan that is rehearsed, so that everyone knows how to escape when fire occurs. The immediate priority when fire occurs is to ensure that any sleeping children are woken from sleep and are immediately taken to a place of safety outside the property, along with all other occupants. The fire and rescue service should always be called without delay, no matter how small the fire.

Note: This user manual is also available in large text and other formats. Please email: technicalsupport@fireangeltech.com or call 0330 094 5830 for further information

TEST YOUR ALARM MONTHLY

Models FA6611, FA6615 & FA6620



EN14604:2005
+AC:2008

Smoke alarm devices
FSTDOP21006

Smoke alarm devices
FSTDOP21007

Model FA6720



EN14604:2005
+AC:2008

Smoke alarm devices
FSTDOP21006

Smoke alarm devices
FSTDOP21007

Technical Support

Online: www.fireangeltech.com/support
E-mail: technicalsupport@fireangeltech.com

Phone: 0330 094 5830

Fire & Rescue Customers: 0800 141 2561
www.fireangeltech.com

Fire & Rescue Customers: 0800 141 2561
www.fireangeltech.com

Fire & Rescue Customers: 0800 141 2561
www.fireangeltech.com

Fire & Rescue Customers: 0800 141 2561
www.fireangeltech.com

Fire & Rescue Customers: 0800 141 2561
www.fireangeltech.com

Fire & Rescue Customers: 0800 141 2561
www.fireangeltech.com

Fire & Rescue Customers: 0800 141 2561
www.fireangeltech.com

Fire & Rescue Customers: 0800 141 2561
www.fireangeltech.com

Fire & Rescue Customers: 0800 141 2561
www.fireangeltech.com

Fire & Rescue Customers: 0800 141 2561
www.fireangeltech.com

Fire & Rescue Customers: 0800 141 2561
www.fireangeltech.com

Fire & Rescue Customers: 0800 141 2561
www.fireangeltech.com

Fire & Rescue Customers: 0800 141 2561
www.fireangeltech.com

Fire & Rescue Customers: 0800 141 2561
www.fireangeltech.com

Fire & Rescue Customers: 0800 141 2561
www.fireangeltech.com

Fire & Rescue Customers: 0800 141 2561
www.fireangeltech.com

Fire & Rescue Customers: 0800 141 2561
www.fireangeltech.com

Fire & Rescue Customers: 0800 141 2561
www.fireangeltech.com

Fire & Rescue Customers: 0800 141 2561
www.fireangeltech.com

Fire & Rescue Customers: 0800 141 2561
www.fireangeltech.com

Fire & Rescue Customers: 0800 141 2561
www.fireangeltech.com

Fire & Rescue Customers: 0800 141 2561
www.fireangeltech.com

Fire & Rescue Customers: 0800 141 2561
www.fireangeltech.com

Fire & Rescue Customers: 0800 141 2561
www.fireangeltech.com

Fire & Rescue Customers: 0800 141 2561
www.fireangeltech.com

Fire & Rescue Customers: 0800 141 2561
www.fireangeltech.com

Fire & Rescue Customers: 0800 141 2561
www.fireangeltech.com

Fire & Rescue Customers: 0800 141 2561
www.fireangeltech.com

Fire & Rescue Customers: 0800 141 2561
www.fireangeltech.com

Fire & Rescue Customers: 0800 141 2561
www.fireangeltech.com

Fire & Rescue Customers: 0800 141 2561
www.fireangeltech.com

Fire & Rescue Customers: 0800 141 2561
www.fireangeltech.com

Fire & Rescue Customers: 0800 141 2561
www.fireangeltech.com

Fire & Rescue Customers: 0800 141 2561
www.fireangeltech.com

Fire & Rescue Customers: 0800 141 2561
www.fireangeltech.com

Fire & Rescue Customers: 0800 141 2561
www.fireangeltech.com

Fire & Rescue Customers: 0800 141 2561
www.fireangeltech.com

Fire & Rescue Customers: 0800 141 2561
www.fireangeltech.com

Fire & Rescue Customers: 0800 141 2561
www.fireangeltech.com

Fire & Rescue Customers: 0800 141 2561
www.fireangeltech.com

Fire & Rescue Customers: 0800 141 2561
www.fireangeltech.com

Fire & Rescue Customers: 0800 141 2561
www.fireangeltech.com

Fire & Rescue Customers: 0800 141 2561
www.fireangeltech.com

Fire & Rescue Customers: 0800 141 2561
www.fireangeltech.com

Fire & Rescue Customers: 0800 141 2561
www.fireangeltech.com

Fire & Rescue Customers: 0800 141 2561
www.fireangeltech.com

Fire & Rescue Customers: 0800 141 2561
www.fireangeltech.com

Fire & Rescue Customers: 0800 141 2561
www.fireangeltech.com

Fire & Rescue Customers: 0800 141 2561
www.fireangeltech.com

Fire & Rescue Customers: 0800 141 2561
www.fireangeltech.com

Fire & Rescue Customers: 0800 141 2561
www.fireangeltech.com

Fire & Rescue Customers: 0800 141 2561
www.fireangeltech.com

Fire & Rescue Customers: 0800 141 2561
www.fireangeltech.com

Fire & Rescue Customers: 0800 141 2561
www.fireangeltech.com

Fire & Rescue Customers: 0800 141 2561
www.fireangeltech.com

Fire & Rescue Customers: 0800 141 2561
www.fireangeltech.com

Fire & Rescue Customers: 0800 141 2561
www.fireangeltech.com

Fire & Rescue Customers: 0800 141 2561
www.fireangeltech.com

Fire & Rescue Customers: 0800 141 2561
www.fireangeltech.com

Fire & Rescue Customers: 0800 141 2561
www.fireangeltech.com

Fire & Rescue Customers: 0800 141 2561
www.fireangeltech.com

Fire & Rescue Customers: 0800 141 2561
www.fireangeltech.com

Fire & Rescue Customers: 0800 141 2561
www.fireangeltech.com

Fire & Rescue Customers: 0800 141 2561
www.fireangeltech.com

Fire & Rescue Customers: 0800 141 2561
www.fireangeltech.com

Fire & Rescue Customers: 0800 141 2561
www.fireangeltech.com

Fire & Rescue Customers: 0800 141 2561
www.fireangeltech.com

Fire & Rescue Customers: 0800 141 2561
www.fireangeltech.com

Fire & Rescue Customers: 0800 141 2561
www.fireangeltech.com

Fire & Rescue Customers: 0800 141 2561
www.fireangeltech.com

Fire & Rescue Customers: 0800 141 2561
www.fireangeltech.com

Fire & Rescue Customers: 0800 141 2561
www.fireangeltech.com

Fire & Rescue Customers: 0800 141 2561
www.fireangeltech.com

Fire & Rescue Customers: 0800 141 2561
www.fireangeltech.com

Fire & Rescue Customers: 0800 141 2561
www.fireangeltech.com

Fire & Rescue Customers: 0800 141 2561
www.fireangeltech.com

Fire & Rescue Customers: 0800 141 2561
www.fireangeltech.com

Fire & Rescue Customers: 0800 141 2561
www.fireangeltech.com

Fire & Rescue Customers: 0800 141 2561
www.fireangeltech.com

Fire & Rescue Customers: 0800 141 2561
www.fireangeltech.com

Fire & Rescue Customers: 0800 141 2561
www.fireangeltech.com

Fire & Rescue Customers: 0800 141 2561
www.fireangeltech.com

Fire & Rescue Customers: 0800 141 2561
www.fireangeltech.com

Fire & Rescue Customers: 0800 141 2561
www.fireangeltech.com

Fire & Rescue Customers: 0800 141 2561
www.fireangeltech.com

Fire & Rescue Customers: 0800 141 2561
www.fireangeltech.com

Fire & Rescue Customers: 0800 141 2561
www.fireangeltech.com

Fire & Rescue Customers: 0800 141 2561
www.fireangeltech.com

Fire & Rescue Customers: 0800 141 2561
www.fireangeltech.com

Fire & Rescue Customers: 0800 141 2561
www.fireangeltech.com

Fire & Rescue Customers: 0800 141 2561
www.fireangeltech.com

Fire & Rescue Customers: 0800 141 2561
www.fireangeltech.com

Fire & Rescue Customers: 0800 141 2561
www.fireangeltech.com

Fire & Rescue Customers: 0800 141 2561
www.fireangeltech.com

Fire & Rescue Customers: 0800 141 2561
www.fireangeltech.com

Fire & Rescue Customers: 0800 141 2561
www.fireangeltech.com

Fire & Rescue Customers: 0800 141 2561
www.fireangeltech.com

1. POSITIONING

In which room should the alarm be installed?

Smoke alarms FA6611, FA6615 and FA6620 are suitable for the landing, hallway, bedroom, living room and dining room.

Heat alarm FA6720 is suitable for the kitchen, garage and loft.

It is advisable to place an FA6611 Escape Light Alarms in a corridor along the escape route to light your path to safety.

Your smoke/heat alarm is suitable for use in mobile homes and caravans. This smoke/heat alarm is not intended for any non-residential, commercial or industrial application, nor for any other purpose than described.

Where in the room should the alarm be installed? Smoke alarms should be sited at least 300mm from light fittings and walls. Ideally as central as possible in the room.

Smoke alarms should be positioned at no more than 600mm vertically below the highest point in the room.

If positioning your smoke alarm on the wall, the top of the detection element must be between 150mm and 300mm below the ceiling, and at least 300mm from any neighbouring wall.

Install your heat alarm at a distance no greater than 5.3m from the farthest wall, no greater than 5.3m from a door to any room in which a fire might start and no greater than 5.3m from the next heat or smoke alarm. Heat alarms should be sited at least 300mm from light fittings and walls. Heat alarms should not be fitted on a wall.

Locations of alarms must be compliant with either BS 5839: Part 6 or relevant Building Regulations if in any doubt.

2. INSTALLATION

Step 1: FA6611 and FA6615 Replaceable battery alarms only

If the alarm requires AA batteries, remove the base plate from the alarm by twisting it anti-clockwise and insert the batteries (matching + to +). This will activate the alarm.



NOTE: For FA6620 and FA6720, the alarm must be installed on the baseplate to activate the alarm. For FA6611 and FA6615, installing the batteries activates the alarm.

After activation, the red LED on the front of the alarm should flash once every 40 seconds (approx.) to show that the alarm is active.

The alarm test sound pattern will be: 3 beeps followed by a 1.5 second pause, then 3 beeps. The LED will flash once per second.

Step 2: Baseplate Installation - all alarms: FA6611, FA6615, FA6620 and FA6720

1. Drill holes into the ceiling (or wall) using the template below and secure the baseplate using the screws provided.



2. Push and twist the alarm clockwise onto the baseplate.



3. Press the Test / ◀ button. The alarm will sound a reduced alarm volume. The FA6611 will also shine the escape light. To hear the alarm at full volume* double press the Test / ◀ button.

*85dB at 3m

91.5mm

3. MAINTENANCE

1. Test the alarm monthly.

Residents can test the alarm by pressing the central Test / ◀ button.

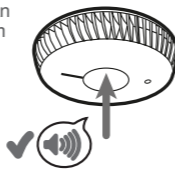

2. Vacuum your alarm every 3 months.



3. Do not use cleaners or solvents.



4. Do not paint the alarm.



5. Replace the alarm every 10 years.

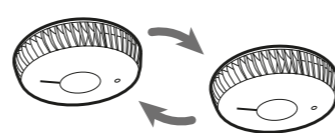

Do not use any other test method except the process described in this manual.

Do not tamper with the alarm as this could cause electric shock or malfunction.

4. LOW BATTERY WARNING

When the alarm battery is low, the alarm will 'chirp' and the Red operational LED will flash once every 40 seconds.

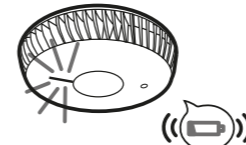

1. For FA6611 and FA6615 Replaceable Battery Alarms

1. Carefully turn the alarm anti-clockwise to remove the device from the baseplate.

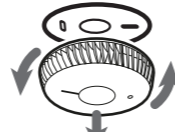

2. Replace the battery immediately (within 30 days).

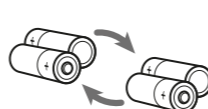

3. Always test the alarm after replacing the batteries.

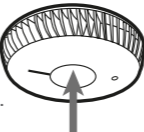

FA6611 or FA6615 alarms require 2 x AA batteries. Under normal use, the battery should last approximately three years for FA6611 and five years for FA6615. Use of a battery other than those recommended here may have a detrimental effect on the alarm: Energizer E91 Alkaline, Duracell AA MN1500 Alkaline, GP AA GN15A Alkaline, Energizer AA L91 Lithium.

2. For FA6620 and FA6720 Sealed Battery Alarms

1. Carefully turn the alarm anti-clockwise to remove the device from the baseplate.

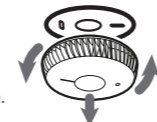

2. Replace the alarm immediately* (within 30 days).

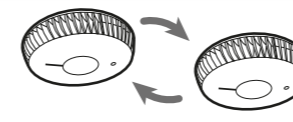

* If your alarm is still under warranty, contact Technical Support.

5. FAULT INDICATION

1. If there is a fault, the alarm will 'chirp' twice and flash twice every 40 seconds.