

MAINS AND BATTERY ✓

Trade Solutions

SMOKE, HEAT, CARBON MONOXIDE AND ENVIRONMENTAL



FireAngel®



Contents

Introduction	4
Technology	6
Solutions	20
Levels of Protection	22
Smart, Connected Homes	24
Data-Driven Solutions	26
Social Housing	28
Private Landlords	30
Products	32
FireAngel Specification	34
Mains + 9V Replaceable Battery	46
Standalone	52
Carbon Monoxide (CO)	56
Environmental	62
Accessories	66
Standards & Regulations	72
BS 5839-6 (Fire Detection)	74
EN 50291-1 (CO Detection)	80
Referencing: Alarm Placement	82
Training and Expertise	84



Since being founded in 1998, home safety technology specialist FireAngel's range of cutting-edge products has continued to evolve and expand, with over 80 million safety devices providing protection for more than 25 million homes.

We are proud to have achieved many industry firsts at FireAngel and hold over 80 granted patents, with our trusted state-of-the-art technology fitted by the UK's Fire and Rescue Services since 2007 and trade professionals nationally.

FireAngel offers a complete choice of mains and battery powered smoke, heat, carbon monoxide (CO) alarms, and environmental solutions suitable for domestic projects across the UK.



SM-SN-1
Specification Multi-Sensor
Smoke Alarm

[Click here to view more >](#)

Why FireAngel?



Extensive range

High performance sensing technology, with Grade D1 and D2 solutions designed to support latest safety recommendations of BS 5839-6.



Designed in the UK

Committed to developing technologies that ensure the highest level of fire and CO detection to ensure properties are safer for all.



Competitive pricing

Economical prices to enhance profit margins, without compromising on quality, with a range of solutions to suit all budgets and specific project requirements.



Technology

Trusted nationally for over 25 years, FireAngel has worked closely alongside UK fire and rescue services and housing providers to develop enhanced safety solutions.

FireAngel are proud to lead the way in smart IoT and AI innovations through the development of advanced solutions, tailored to the needs of both UK housing and installers. Our success has been driven by robust partnerships and successful integration within the social housing, private landlords and fire and rescue services.



Available nationwide from all leading trade wholesalers, our high performance products are the right choice for your next project.



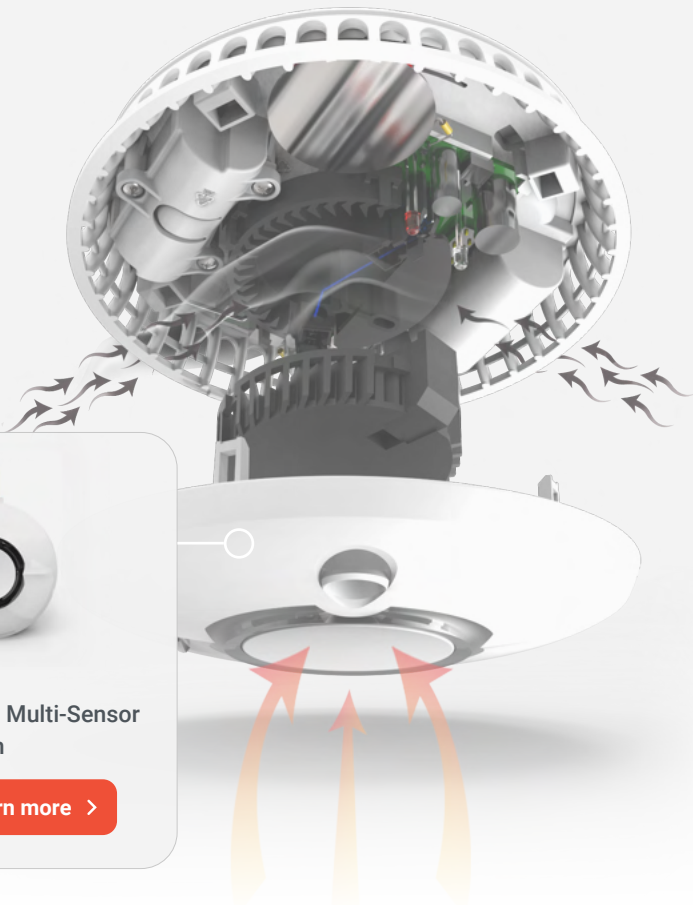

FS2126-T

Specification Multi-Sensor
Smoke Alarm

[Click to learn more >](#)

Found within FireAngel's Specification range of smoke alarms, Thermoptek multi-sensing technology provides a faster alert to danger and is the technology of choice for the UK Fire and Rescue service.

Thermoptek technology provides a much faster response to all fire types by combining an optical sensor with thermal enhancement and two separate sensing elements. The different sensing elements constantly monitor for smoke and temperature increase. If a temperature rise is detected, the sensitivity of the smoke alarm is increased to provide a quicker response time.

FireAngel's Specification heat alarms contain Thermistek enhanced sensing technology which supports a reduced reaction time to fires within the kitchen - the most dangerous room in a property.

Almost half of domestic fires start in kitchens, which makes Thermistek technology critical with providing extra time to react. The technology constantly monitors for temperature change and using a predictive algorithm, if the temperature rises at a dangerous rate it will activate full alarm mode.



FS1226-T

Specification Enhanced
Heat Alarm

[Click to learn more >](#)



Watch the Smart RF
connection video >

Wireless Technology

In addition to patented technology, FireAngel's advanced Specification range also features Smart RF wireless technology to offer an interlinked, cost effective system. This provides the capability to wireless interlink devices allowing greater network flexibility to future-proof properties as resident needs change or legislation evolves, so when one alarm sounds, they all sound.

Smart RF Interlinking allows installers to:

- Create wireless interlinked networks of battery devices (without hardwired interlink)
- Create hybrid networks where hardwired interlinked mains powered devices are able to wirelessly interlink to battery powered devices which are fitted with a module





Remotely monitor interlinked safety and environmental sensors, access real-time status and compliance updates, and view instant diagnostics reports for **a more efficient, intelligent way to manage properties and protect residents.**

Watch the FireAngel Connected video >

IoT-Powered Resident Protection

CONNECTED IS A PURPOSE-BUILT SOLUTION FOR HOME SAFETY.

With Connected, data is monitored in real-time to alert landlords to properties at risk of damp and mould, or a future fire. It also provides a view of the status of alarms in a property, for example if removed, triggered or in need of maintenance, eliminating wasteful visits, staff time and administration fees.

The solution can be deployed within the parameters of an existing budget, using cellular connectivity with optional Wi-Fi back-up, and comes with Zigbee connectivity as standard, allowing multiple Zigbee sensors, such as water leak detectors and air quality monitors to be installed, offering tailored protection for residents and properties.

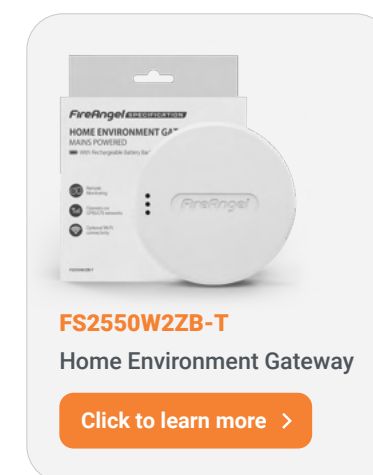



**Predict high risk
alert triggered**



Pinpointing Fire Risk with FireAngel Predict®

Developed with support from the UK Fire and Rescue Service, FireAngel Predict® spots trends of behaviours logged by smoke and heat alarms, creating a map of fire safety triggers and categorising properties as high or low risk.

✓ Tried and Tested

Tried, tested and trusted after 10 years of development, Predict® gives visibility of previously hidden trends in social housing properties, such as alarms activating through the night or devices being removed.

🔥 Mitigate Risk

Automatically highlighting potentially dangerous behaviours to social housing providers enables active resident-centric intervention to mitigate risk. While a personalised Safe and Well check by the Resident Safety Team or Fire and Rescue Services helps to prevent a life-threatening event.

📊 Streamlined Data

FireAngel Predict® also processes, sorts and structures real time data in the Connected system, instantly pinpointing those most at risk in our communities and removing the need for manual data crawls over spreadsheets by social housing associations.

Find out more about **Predict®** >

Streamline Data to Provide Actionable Insight

with Connected Dashboard

Find out more & watch the
FireAngel Connected video >

The FireAngel Connected cloud-based dashboard reports real-time, GDPR compliant, data for individual properties and devices.

Using the dashboard, social landlords can quickly access the most important information with an instant overview of urgent active and Predict® notifications to support with effective resource management.

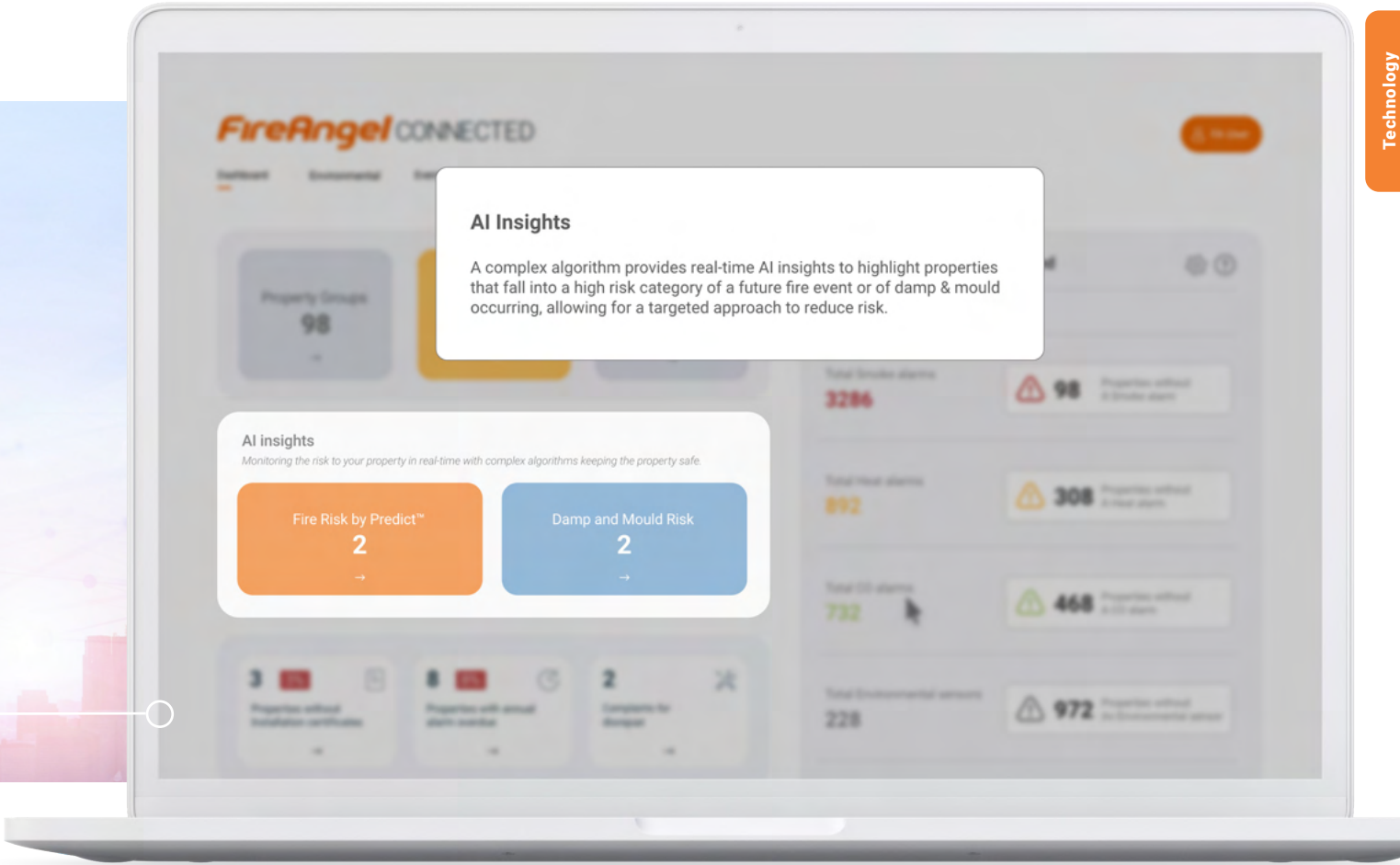

Every aspect of a device is captured and logged automatically on the system, including installation training and compliance records, to comply with Dame Judith Hackitt's 'Golden Thread' of digital information of a building.

Installation images and location identifiers arm maintenance teams with full insight before any site visit. Once an installation is complete, each property will be signed off by a FireAngel trained installer – providing an instant digital certificate of compliance against BS 5839:6.

Connected provides valuable insights through its dashboard and supports seamless integration with a landlord's preferred asset management system via open-source API code. This integration facilitates centralised access to device and property data, eliminating the need for manual data searches and staff training on multiple tools.

From within the installation dashboard, housing providers can view full alarm history reports for individual properties and perform a recorded test event remotely. This can either be a sound test, with a resident's go ahead, or a silent test across all alarms within a property.

Sync-It™))) (NFC) technology

 **Damp & Mould**
High humidity detected

 **Temperature / Humidity Sensor**
FA3328-EUT

 **Diagnostics Report**
Free Installer App
[Click to learn more >](#)





 **Sync-It™**
NFC Technology



Home Environment Data Capture

CAPTURE HOME ENVIRONMENT DATA WITH RAPIDLY DEPLOYED SENSORS.

FireAngel's FA3328-EUT sensor allows simple data collection for housing providers and maintenance teams. Using Sync-It™ (NFC) technology, extracting data from a device through the free installer app is quick, quiet and contactless.

-  **Environmental Data**
Monitor environmental property data with average temperature and humidity levels recorded
-  **Digital Reports**
Digitally file proof of maintenance reports & compliance record levels recorded
-  **CO Levels**
View average CO levels over a period of time
-  **Alarm Data**
See previous alarm activations



FA3328-EUT
Temperature and Humidity Sensor with Carbon Monoxide Alarm
[Click to learn more >](#)

Solutions

FireAngel offer standalone and interlinked devices alongside connected technology and smart IoT solutions. Our solutions offer a holistic network of protection, detection and prevention that is scalable and adaptable in the future, to provide increased safety and reassurance for housing providers, landlords and residents.

FireAngel's range of easy to install smoke, heat and carbon monoxide (CO) alarms feature innovative, patented technologies and comply to the latest legislative requirements.



Levels of Protection

FireAngel Specification sets the standard for performance, meets current legislation and fulfils the needs of all domestic projects.

Our advanced yet easy to install range of alarms can be continuously adapted and upgraded to provide three levels of unrivalled protection.

Basic Protection Standalone (not interlinked)

Install standalone units using existing mains powered networks or add battery powered devices as necessary.

Effortless retrofit - Our Specification units streamline installation with a base plate seamlessly covering existing fixings.



[Click to learn more](#) >

[View products](#) >

Enhanced Protection Interlinked networks

Create an interlinked network via hardwire or wireless connection. Add mains and/or battery powered devices into a single network so when one sounds, they all sound.

Hybrid networks - Making retrofit installations simple. Build an interlinked mixed system of Specification mains and battery powered alarms. You can also add additional devices into an existing network at any time.

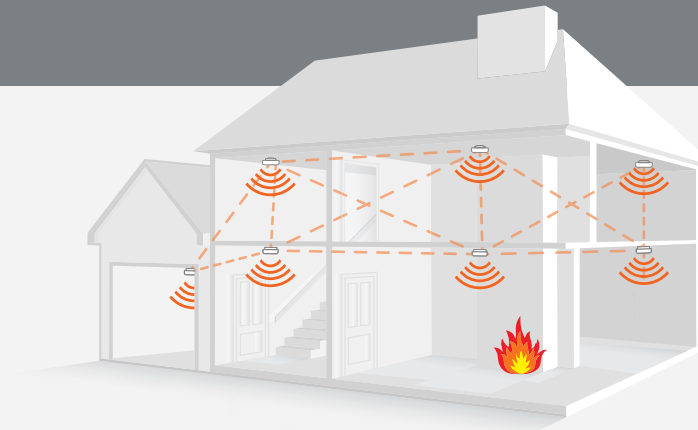

 FireAngel Recommend

[Click to learn more](#) >

[View D1 & F1 products](#) >

[View D2 products](#) >

Maximum Protection Connected smart IoT technology

Designed for social and private landlords to provide an instant view of property risk level and device data. Our Connected technology offers a secure way of confirming fire & CO compliance, without the need to enter a property. It can also offer additional environmental insights so social landlords are able to provide the highest level of protection for their residents.

Connected data - For full data overview via the Connected dashboard, add a gateway.

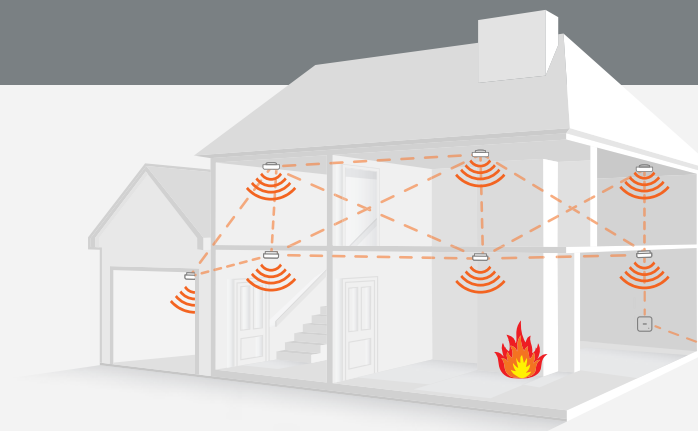

 FireAngel Recommend

[Click to learn more](#) >

[View products](#) >

Smart, Connected Homes

Designed for social housing providers and housebuilders, our Connected solutions offer smart data insights to transform property monitoring and maintenance practices and ensure safer homes for all.

Recommended Products:

	SM-SN-1 + FS1521W2-T Specification Multi-Sensor Smoke Alarm and Module		HM-SN-1 + FS1521W2-T Specification Kitchen Heat Alarm and Module
	FS1326-T + FS1521W2-T Specification Carbon Monoxide Alarm and Module		FS2550W2ZB-T Home Environment Gateway

Zigbee Sensors

	Temperature + Humidity Sensor		CO ₂ and Temperature + Humidity Sensor		Water Leak Detector
---	-------------------------------	---	---	---	---------------------

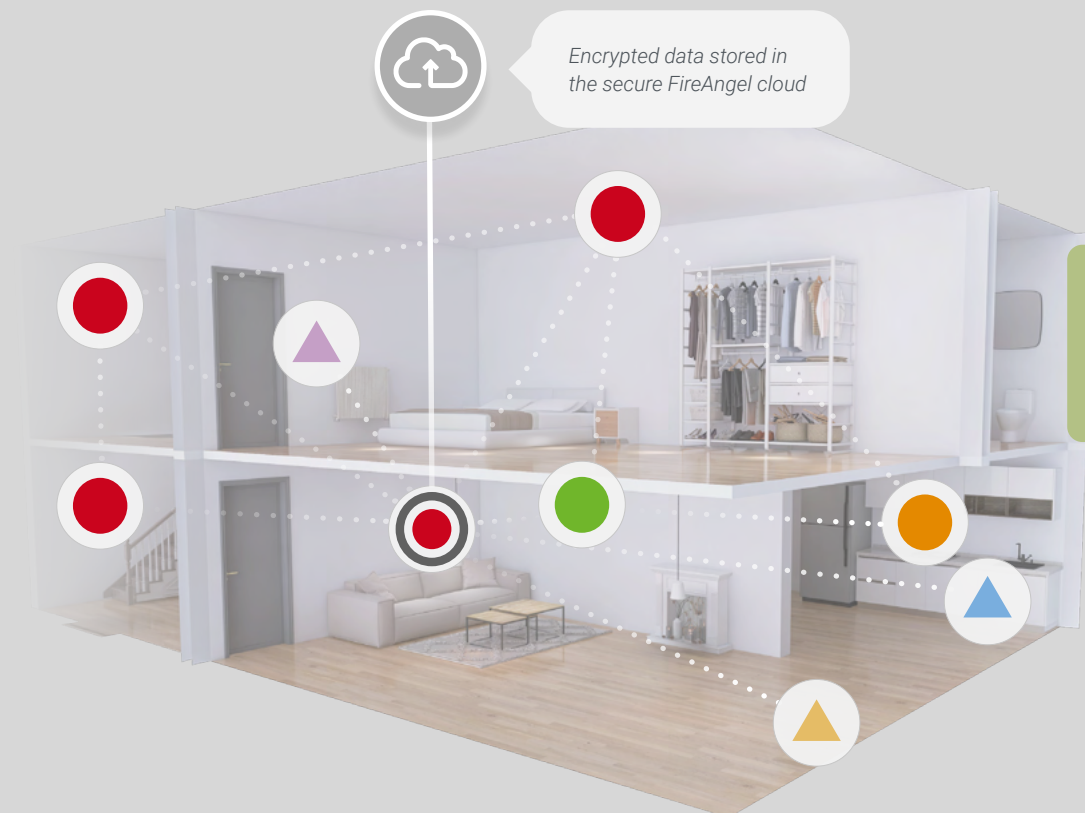

The gateway to safety: FS2550W2ZB-T

FireAngel's Home Environment Gateway offers a complete safety solution, with fire safety through our patented FireAngel Predict® technology and on-board environmental monitoring. With real-time insights and automated reporting, optionally feeding into existing asset management tools, the solution delivers data without requiring additional resources.

Third party integration with Zigbee sensing

Equipped with Zigbee connectivity as a standard feature, housing providers can confidently anticipate scalable and expandable monitoring of a property's ecosystem, ensuring heightened safety and reassurance in the future. The seamless integration of sensors for temperature, humidity, air quality, water leak detection, and forthcoming devices, aligned with evolving needs and legislation, is both swift and cost-efficient.

A smart approach to futureproofing homes

The Social Housing (Regulation) Act 2023 also includes Awaab's Law, providing more protection to residents in homes affected by damp and mould, with strict new time limits outlined for social landlords to investigate a reported problem. Our smart environmental solutions support legislative changes by utilising smart IoT technology.

Explore our solutions, offering intelligent data insights for effective property monitoring to prevent damp and mould. [Book a meeting today.](#)

Data-Driven Solutions

Supporting the Housing Ombudsman's directive to gather data on damp and mould, FireAngel provides a standalone device that can be instantly used in properties to monitor and capture environmental and CO data over time.

Recommended Products:

-  **FS2126-T + FS1521W2-T**
Specification Multi-Sensor Smoke Alarm and Module
-  **FS1226-T + FS1521W2-T**
Specification Kitchen Heat Alarm and Module
-  **FA3328-EUT**
Temperature and Humidity Sensor with Carbon Monoxide Alarm

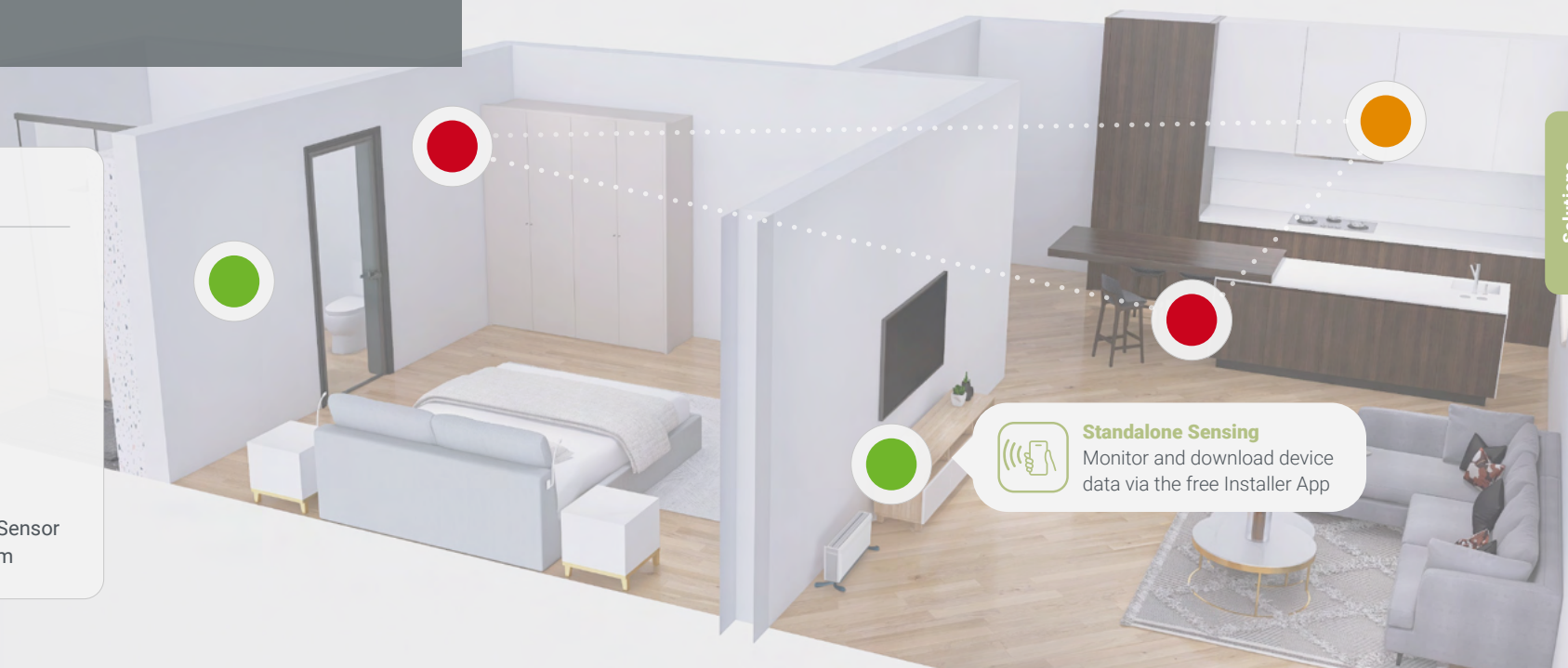

Rapidly deploy environmental data capture with FA3328-EUT

Facilitating thorough data capture within a property, the FireAngel Sync-It™ device logs temperature, humidity, and carbon monoxide levels over time. This information is seamlessly transmitted to the cloud during maintenance visits, and is easily activated through a free app. Providing an insightful overview of environmental factors, this empowers housing providers to pinpoint properties at risk of damp, mould, or disrepair.

Provide additional carbon monoxide protection

In addition to a comprehensive data set of temperature, humidity, and carbon monoxide levels over time, the device serves a dual purpose as a carbon monoxide alarm. Upon detecting hazardous levels or a rapid rise in CO, the device promptly signals with a clear, loud alarm, ensuring residents have ample time to evacuate in the face of potentially lethal gas.

Be prepared for evolving guidance and compliance

The Housing Ombudsman's Spotlight report on damp and mould in social housing prompted a sector-wide call for landlords to adopt a zero-tolerance, data-driven approach. Government guidance in September 2023 emphasised the importance of landlords taking tenant reports of damp or mould seriously and encourages a proactive stance to minimize the risk in properties.



Our solutions help identify properties in disrepair or at risk of developing damp and mould, **book a meeting with our team today**



Solutions for Social Housing

As pressure mounts on social landlords to remain compliant with ever-changing legislation, FireAngel offer adaptable and tailored solutions to ensure compliance and maintain resident safety so all housing types can remain protected.

Recommended Products:

-  **SM-SN-1 + FS1521W2-T**
Specification Multi-Sensor Smoke Alarm and Module
-  **HM-SN-1 + FS1521W2-T**
Specification Kitchen Heat Alarm and Module
-  **FS1326-T + FS1521W2-T**
Specification Carbon Monoxide Alarm and Module
-  **FS2550W2ZB-T**
Home Environment Gateway

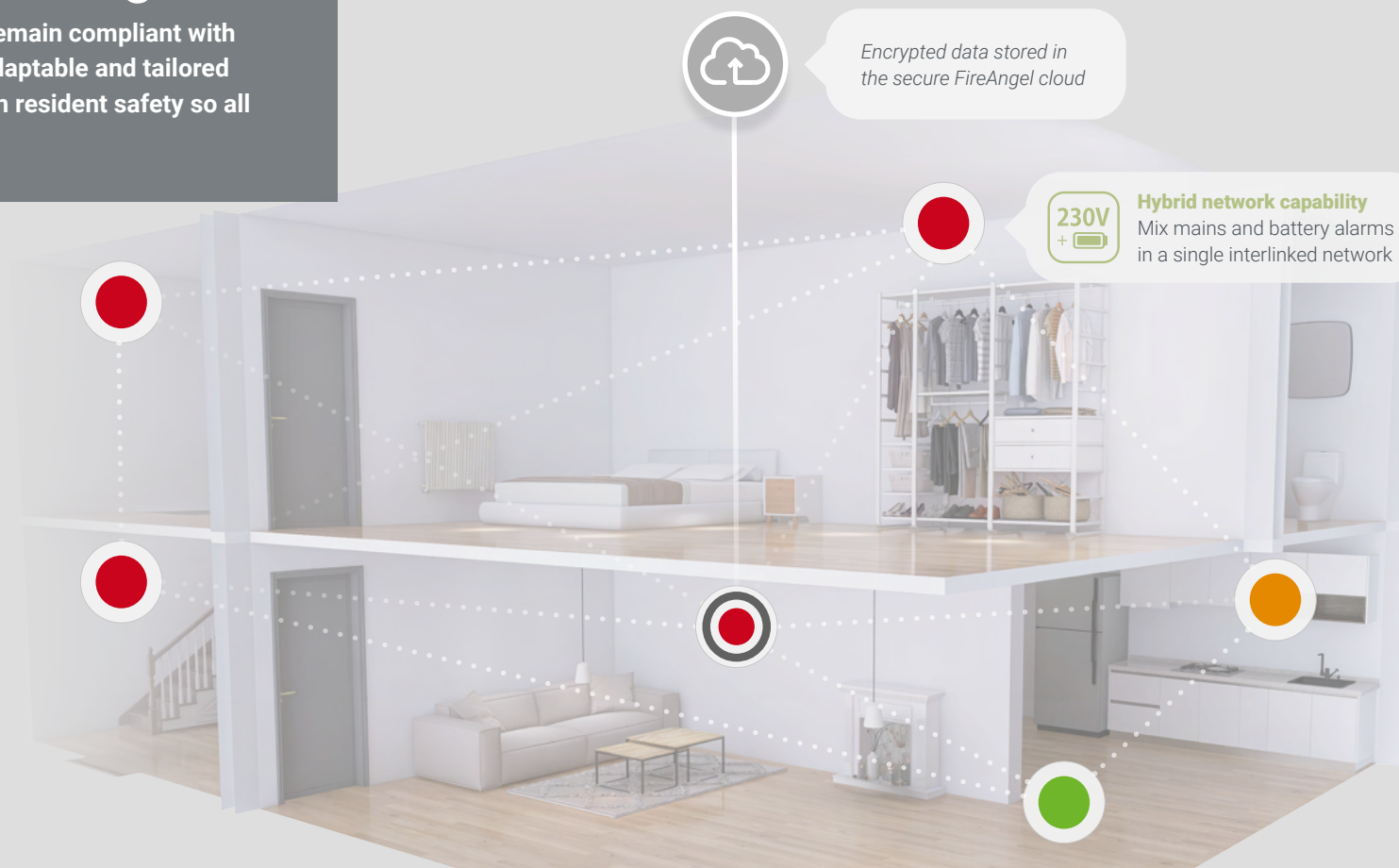

When looking at the overall quality of life of residents, fire safety is a critical element, as is carbon monoxide and gas safety. Today, we have unique technology to increase safety measures even further and also look at temperature and humidity within a property. Additional benefits include software integration with other care and protection technologies to further enhance safety for vulnerable people in society.

Even when resource and budgets are limited, technology like FireAngel Connected can still benefit housing associations and local authorities to enable proactive safety solutions whilst taking a holistic approach to ensure that the quality of life of residents is improved.

From a flat in a high rise tower block to a three bed terraced house, our solutions provide safety for all property types. Together we can discuss how FireAngel's solutions can support quick wins, long-term digital transformation and retrofit projects. FireAngel have scalable and adaptable solutions for all properties requiring fire and CO safety and environmental monitoring.





For a bespoke solution tailored to your social housing portfolio,
book a meeting with our team today



Solutions for Private Landlords

Legislation surrounding smoke and carbon monoxide alarms in private rental properties has evolved over recent years across the UK. We can support landlords to provide the highest standard of protection for residents.

Recommended Products:

-  **FS2126-T + FS1521W2-T**
Specification Multi-Sensor Smoke Alarm and Module
-  **FS1226-T + FS1521W2-T**
Specification Kitchen Heat Alarm and Module
-  **FS1326-T + FS1521W2-T**
Specification Carbon Monoxide Alarm and Module
-  **FS1580W2-T**
Spec Connected Wireless Gateway

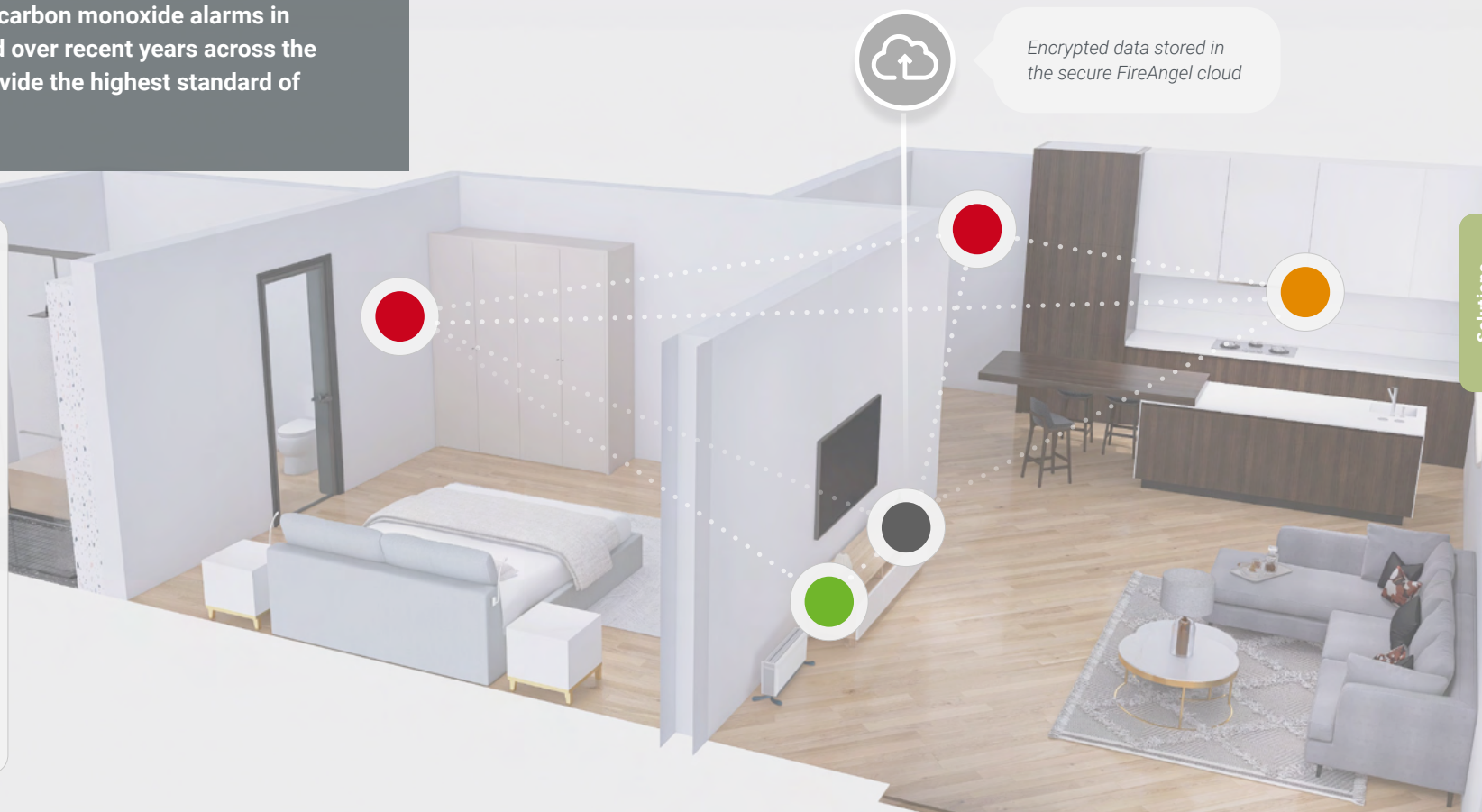

Increase protection with our Spec Connected Gateway

Designed for private properties, fit a gateway alongside a network of FireAngel Specification range of alarms to enable connection to the free FireAngel App (iOS & Android compatible). Install during initial alarm installation, or add at any time in the future to access data.

Visibility for multiple properties in a single app

Not only can you enable instant notifications and easy testing using a smart device, you can add unlimited properties to the app, allowing a customer with a small portfolio of private housing to monitor their alarms remotely - receiving alerts if an alarm is activated, taken off its base or needs replacing.

FireAngel can support landlords in providing the highest standard of protection for residents. We offer a wide range of cost-effective solutions to ensure secure and compliant property portfolio management.

For a bespoke solution tailored to the needs of private landlords, [book a meeting with our team today](#) >

Products

FireAngel's easy to install smoke, heat and carbon monoxide (CO) alarms feature **innovative, patented technologies** and comply to the latest legislative requirements.

WHAT DOES FIREANGEL'S EXTENSIVE RANGE OFFER?

- Mains and battery powered products
- Standalone, wireless or hardwire interlinked networks
- Connected technology and smart IoT solutions
- Environmental monitoring via semi-connected products or smart solutions
- Suitable for all projects and budgets including social housing
- Solutions are scalable and can be adapted in the future



FireAngel Specification

Grade D1 / F1

Designed with installers in mind, this compliant, flexible and easy to fit range delivers advanced sensing technology including Smart RF wireless interlink (hardwired, wireless or a mixed system) ensuring your domestic installations are safe for years to come.

RANGE ECOSYSTEM: 10 YEAR SPECIFICATION



SM-SN-1 (Mains)
Multi-Sensor Smoke Alarm



FS2126-T (Battery)
Multi-Sensor Smoke Alarm



HM-SN-1 (Mains)
Kitchen Heat Alarm



FS1226-T (Battery)
Kitchen Heat Alarm



FS1326-T
Carbon Monoxide Alarm



FS1552W2-T
Combined Strobe and Pad



FS1524W2-T
Wireless Alarm Control Unit



INTERLINK THE RANGE: HARDWIRE

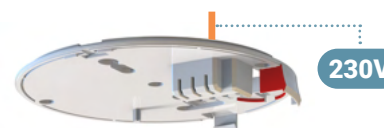

In line with latest standards, our mains powered Specification products can be easily hardwire interlinked - see page 44.



INTERLINK THE RANGE: VIA WIRELESS MODULE



FS1521W2-T
Specification Smart RF Module

Enables wireless interlink for multiple devices



UPGRADE TO CONNECTED IoT: ENABLES DATA INSIGHTS



FS1580W2-T
Wireless Gateway
For private rented properties



FS2550W2ZB-T
Home Environment Gateway
For social housing properties





Thermoptek technology

Multi-sensing technology used in our thermally enhanced optical Specification smoke alarms



Create a network with Smart RF

Fit a Smart RF Module for wireless compatibility to interlink multiple alarms



Thermistek technology

Enhanced technology used in our Specification heat alarms to ensure a rapid response to fire



Supplied with a dust cap

Prevent dust or paint entering a device during installation or building projects to maximise longevity of the alarms



SM-SN-1

Specification Multi-Sensor Smoke Alarm

Mains Powered with 10 Year Lithium Battery Back-up

Grade D1

[View online >](#)

- For use in hallway, landing, living room, dining room and bedrooms
- Contains optical multi-sensing Thermoptek patented technology, for rapid detection to all types of fires
- BS EN 14604:2005+AC:2008
- Compatible with our Connected Home Solution, with a Gateway added to the network



FS2126-T

Specification Multi-Sensor Smoke Alarm

10 Year Sealed Lithium Battery

Grade F1

[View online >](#)

- For use in hallway, landing, living room, dining room and bedrooms
- Contains optical multi-sensing Thermoptek patented technology, for rapid detection to all types of fires
- BS EN 14604:2005+AC:2008
- Compatible with our Connected Home Solution, with a Gateway added to the network



HM-SN-1

Specification Kitchen Heat Alarm

Mains Powered with 10 Year Lithium Battery Back-up

Grade D1

[View online >](#)

- For use in kitchen, garage and loft
- Provides class A1 heat detection (54°C-65°C) and features Thermistek technology, with a unique radiant heat dish, for a faster response to fire
- BS 5446-2:2003
- Compatible with our Connected Home Solution, with a Gateway added to the network



FS1226-T

Specification Kitchen Heat Alarm

10 Year Sealed Lithium Battery

Grade F1

[View online >](#)

- For use in kitchen, garage and loft
- Provides class A1 heat detection (54°C-65°C) and features Thermistek technology, with a unique radiant heat dish, for a faster response to fire
- BS 5446-2:2003
- Compatible with our Connected Home Solution, with a Gateway added to the network

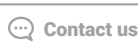



Compliant with regulations

Suitable for all homes and meets latest UK regulations in England, Scotland, Wales and Ireland



Create a network with Smart RF

Fit a Smart RF Module for wireless compatibility and interlink multiple alarms



FireAngel Connected

Simply add a FireAngel Gateway to activate our Connected cloud-based platform



Future-proofed protection

Upgrade and adapt your installations when needed to ensure maximum protection at all times



FS1326-T

Specification Carbon Monoxide (CO) Alarm

10 Year Sealed Lithium Battery



FS1521W2-T

Specification Smart RF Module

10 Year Lithium Battery



FS1580W2-T

Spec Connected Wireless Gateway

Mains Powered with Ethernet Connection

Property Portfolio Management

Unlimited properties can be added to the FireAngel Connected app, allowing a customer, with a small portfolio of private housing to monitor their alarms remotely - receiving alerts if an alarm is activated, taken off its base or needs replacing.



[View online >](#)

- For use in any room with a fuel burning appliance and main living spaces
- Features an advanced electrochemical sensor
- EN 50291-1:2018 & EN 50291-2:2019
- Fit a Smart RF Module for wireless compatibility

[View online >](#)

- Works with all Specification devices
- Fit this Smart RF Module within Smart RF Ready devices to wireless interlink multiple devices on a single network, including a FireAngel Connected Gateway
- Quick and easy installation - simple to place into alarm
- RF transmitter and receiver in each module for high performance

[View online >](#)

- Quick and easy connected solution designed for private landlords featuring patented Predict® technology
- Works with Specification alarms - create a new network or upgrade an existing network at any time
- Certified to EN 300 220-2, EN 301 489-3, EN 301 489-1
- Easy to fit using Ethernet connection
- Allows remote monitoring with optional instant notifications and easy testing of Specification Smart RF enabled products via the FireAngel app
- See status of alarms in a property, for example if removed, triggered or in need of maintenance
- Secure cloud system - device data is stored within the FireAngel cloud





FireAngel SPECIFICATION



Proactive prevention

Prevent damp and mould with environmental monitoring of temperature and humidity



Future-proofed protection

Cost-effectively upgrade and adapt your installations to ensure maximum protection



FS2550W2ZB-T

Home Environment Gateway

Mains Powered with Rechargeable Battery Back-up

[View online >](#)

The Home Environment Gateway provides a holistic resident safety solution, encompassing fire safety, AI-driven risk analysis and environmental monitoring to ensure compliance and proactive maintenance in properties.

[Explore how Home Environment Gateway addresses UK housing requirements >](#)

- Enables social housing providers to prioritise condensation, damp and mould interventions and increase fire prevention measures
- Features patented Predict® technology and in-built temperature and humidity sensors with automatic reporting to FireAngel's Connected cloud platform
- Can occupy the same footprint (use as the base plate) for one FireAngel Specification mains powered alarm, so no additional wiring is required
- Connects wirelessly via Smart RF to chosen network of devices and continually monitors alarms, creates a link between FireAngel Specification, Zigbee devices and FireAngel's Connected cloud platform
- Equipped with LTE/GPRS Cellular and Wi-Fi connectivity options
- For use in any room within a home (except bathroom and kitchens)

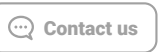



Ultimate protection

Our products feature innovative technologies and comply to the latest legislative requirements



Create a network with Smart RF

Fit a Smart RF Module for wireless compatibility to interlink multiple alarms



Enhance protection

Cost-effectively upgrade and adapt your installations to ensure maximum protection at all times



Future-proofed protection

Works with our Connected Home Solution for enhanced fire protection and enhanced resident safety



FS1524W2-T

Specification Wireless Alarm Control Unit

10 Year Sealed Battery

[View online >](#)

- Features Smart RF wireless technology and works with all Specification devices including our Connected Home Solution
- Easily test, silence and locate Smart RF enabled wireless alarms
- Memory function flashes if alarm has activated
- Suitable to assist the elderly, disabled or residents in properties with high ceilings



FS1552W2-T

Specification Combined Strobe and Pad

Mains Powered with Rechargeable Battery Back-up

[View online >](#)

- Features Smart RF wireless technology and works with all Specification devices including our Connected Home Solution
- Designed to provide an alert to those with hearing loss, who may not hear an audible alarm
- Flashing strobe provides visual warning for waking hours, while vibrating pad can be placed under a pillow or mattress



EXS230-1

Weatherproof External Sounder

Mains Powered

[View online >](#)

- Install alongside the Mains Powered Relay (RLYM-1EU) enabling connectivity into the Specification network of protection
- Low current consumption and high SPL in a robust fire retardant housing
- Suitable for all general signalling applications including fire, security and process control with 100dB(A) output



RLYM-1EU

Specification Relay - Hardwired

Mains Powered with Battery Back-up

[View online >](#)

- Connect fire and CO alarms to external devices such as fire doors and other Telecare systems
- Ultra slim design with "pulse signal" or a "continuous switched signal" options
- Hardwire interlink to a mains powered Specification smoke (SM-SN-1) or heat alarm (HM-SN-1)
- Wireless only relay also available (WRLYM-1EU)





HOW TO INSTALL FIREANGEL SPECIFICATION (MAINS)

*If you are creating a wireless network, add a Smart RF module (FS1521W2-T) module at this stage and follow the pairing instructions in the manual. Mains powered alarms have been used for example purposes.

1 FIRST FIX



- 1 Attach optional shroud to the base plate and remove the terminal block cover. Secure the base plate to the ceiling.
- 2 Feed the mains wire through the base plate and install the wiring into the terminal block as shown in the manual and fit terminal cover.

2 SECOND FIX

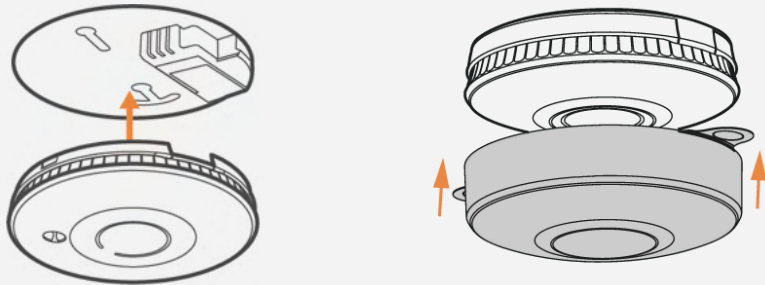

- 3* Line up the alarm with the base plate and gently apply pressure until the alarm clicks into place. Switch on mains electricity supply.
- 4 Check green LED is on and test alarm. Add the dust cap to protect the alarm until all building work is complete.

IN PREPARATION FOR THE RESIDENT

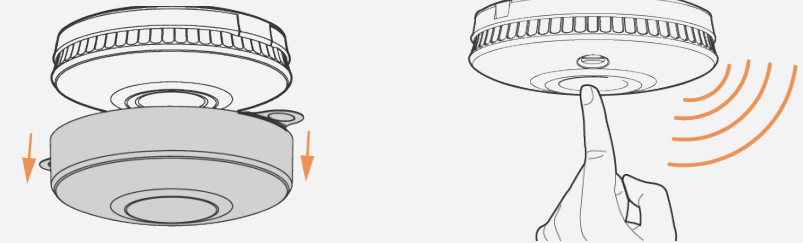

- 5 Remove the dust cap once all building work is complete.
- 6 Complete a final test of the alarm and ensure there are no amber fault lights present.



Discreet, easy release mechanism

Free bespoke product and installation training available >

Follow step-by-step guidance on installing FireAngel devices >

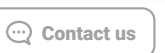

FireAngel Mains + 9V Replaceable Battery Range

Grade D2

Our mains powered with replaceable 9V battery back-up range is ready to hardwire interlink, or can be wireless interlinked using the RF-BW-T base. This competitively priced range, which doesn't compromise on quality, supports installers in providing a cost-effective fire and CO protection for residential properties including new build projects.



RANGE ECOSYSTEM: MAINS + 9V REPLACEABLE BATTERY



SW1-PF-T

Optical Smoke Alarm



HW1-PF-T

Kitchen Heat Alarm



CW1-PF-T

Carbon Monoxide Alarm



CONNECT THE RANGE: WIRELESS



Learn more on
how to connect



RF-BW-T

RF Interlink Push-Fit Base

Compatible with SW1-PF-T, HW1-PF-T, CW1-PF-T for wireless interlink.

The RF base provides a wireless interlink between mains powered smoke, heat & CO alarms so when one alarm sounds, they all sound. Quick to install and simple to link.



CONNECT THE RANGE: HARDWARE



Learn more on
how to connect



Our Mains + 9V replaceable battery range comes with a Push2Fit base as standard, offering a quick and easy 3-step installation.

For enhanced protection, this range allows hardwire interlink for up to 12 smoke, heat or CO alarms - see page 50 for installation guidance.





Easy installation

Push fit base specifically designed for easy installation. Align arrows to ensure robust and secure connection



Interlink networks

Hardwire interlink up to 12 SW1, HW1, CW1 devices or use RF-BW-T base to wireless interlink multiple alarms



Long-life product

10 year product life with replaceable 9V battery for smoke, heat and carbon monoxide alarm



Suitable for new build properties

Greater resistance to power surges offering reliable performance suited for new build projects



SW1-PF-T

Optical Smoke Alarm

Mains Powered with Replaceable 9V Battery Back-up

Grade D2

[View online >](#)

- For use in hallway, landing, living room, dining room and bedrooms
- Optical sensing technology reduces nuisance alarms
- EN 14604:2005+AC:2008
- Supplied with push fit base
- Dust cap supplied to prevent dust or paint entering a device during installation or whilst building projects are in progress



HW1-PF-T

Kitchen Heat Alarm

Mains Powered with Replaceable 9V Battery Back-up

Grade D2

[View online >](#)

- For use in kitchen, garage and loft
- Provides class A2 heat detection (54°C-70°C) with advanced thermistor sensing technology
- BS 5446-2:2003
- Supplied with push fit base
- Dust cap supplied to prevent dust or paint entering a device during installation or whilst building projects are in progress



CW1-PF-T

Carbon Monoxide Alarm

Mains Powered with Replaceable 9V Battery Back-up

[View online >](#)

- For use in any room with a fuel burning appliance and main living spaces
- Features electrochemical sensing technology for rapid CO detection
- EN 50291-1: 2018
- Supplied with push fit base
- Dust cap supplied to prevent dust or paint entering a device during installation or whilst building projects are in progress



RF-BW-T

RF Interlink Push Fit Base

10 Year Lithium Battery

[View online >](#)

- Base enables wireless interlink between multiple SW1-PF-T, HW1-PF-T and CW1-PF-T alarms
- Quick to install and easy to link, ideal when refurbishing or extending an existing property
- RF transmitter and receiver in each base unit for high performance

Please note, RF-BW-T will not interlink to Specification Smart RF products



HOW TO INSTALL FIREANGEL MAINS + 9V BATTERY RANGE

1 FIRST FIX

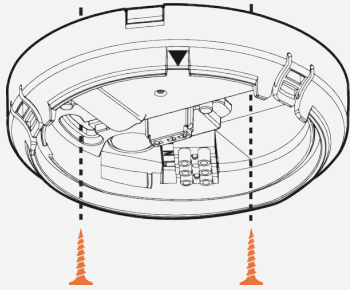

1. Remove the terminal block cover. Secure the base plate to the ceiling.

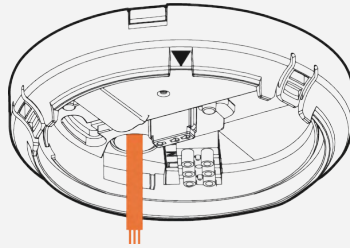

2. Feed the mains wire through the base plate and install the wiring into the terminal block as shown in the manual.

2 SECOND FIX

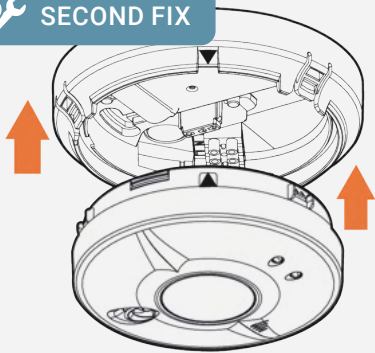

3. Line up the alarm with the base plate and gently apply pressure until the alarm clicks into place. Switch on mains electricity supply.*

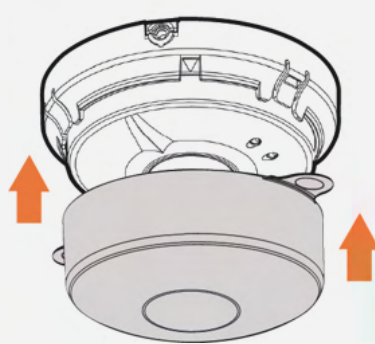

4. Check green LED is on and test alarm. Add the dust cap to protect the alarm until all building work is complete.

*If you are using the RF base plate (RF-BW-T), please follow the interlink steps shown in the manual. Mains powered alarms have been used for example purposes.

IN PREPARATION FOR THE RESIDENT

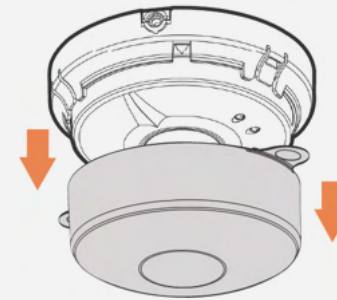

5. Remove the dust cap once all building work is complete.



6. Complete a final test of the alarm and ensure there are no fault lights present.



Free bespoke product and installation training available >

Follow step-by-step guidance on installing FireAngel devices >

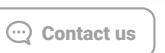

FireAngel Standalone Range

Grade F1 / F2

Our standalone alarms are ideal for installations where cost and quality are a priority.



RANGE ECOSYSTEM: STANDALONE



ST-622T (Battery)
Multi-Sensor Smoke Alarm



SB1-T (Battery)
Optical Smoke Alarm

UPGRADE TO D1 OR D2 PROTECTION



ENHANCE FIRE AND CO PROTECTION WITH INTERLINKED NETWORKS

Check out our advanced technology providing adaptable networks and suitable for all domestic installations. Our additional product ranges can be hardwire or wireless interlinked to suit all installations.

[D1 Specification range >](#)

[D2 Mains 9V range >](#)



Easy installation

A quick and easy solution that provides instant protection with no interlinking required



Independent protection

Smoke alarms can be installed in a hallway, landing, living room, dining room and bedroom



ST-622T

Multi-Sensor Smoke Alarm

10 Year Sealed Lithium Battery

Grade F1

[View online >](#)

- For use in hallway, landing, living room, dining room and bedroom
- Contains optical multi-sensing Thermoptek patented technology, for rapid detection to all fires
- BS EN 14604:2005+AC:2008
- Easy install with automatic battery engagement on base plate



SB1-T

Optical Smoke Alarm

1 Year Replaceable Battery

Grade F2

[View online >](#)

- For use in hallway, landing, living room, dining room and bedroom
- Optical sensor
- BS EN 14604:2005+AC:2008
- 10 year product life
- Suitable for low-cost budget installations requiring basic fire protection

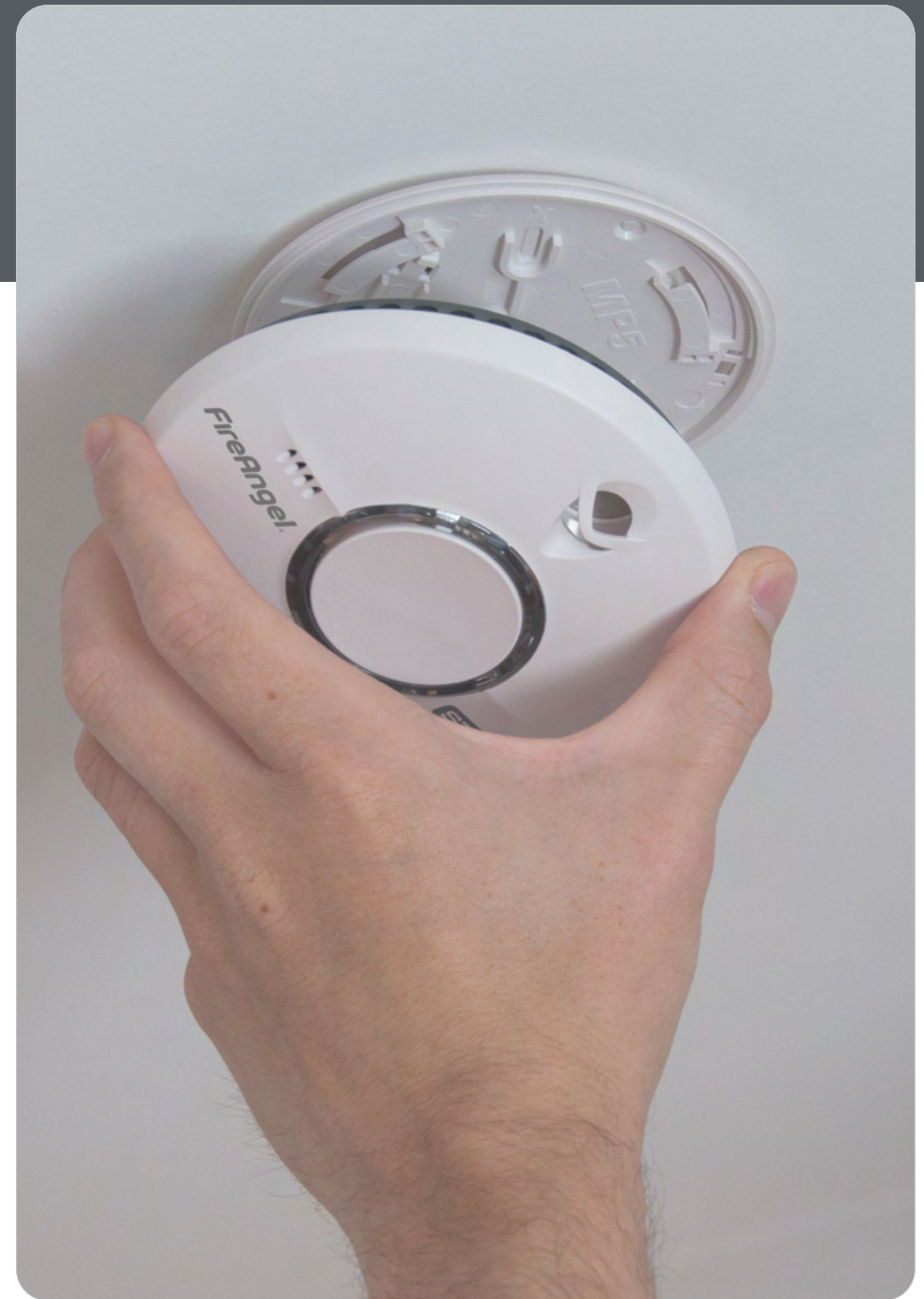

FireAngel Carbon Monoxide (CO) Range

As recommended in BS 50292:2023, CO alarms should be installed in any rooms that contain a fuel burning appliance or have a flue running through it. FireAngel's advanced CO alarms offer enhanced sensing for rapid detection.



RANGE ECOSYSTEM: 10 YEAR CO ALARMS

10 YEAR SEALED BATTERY:



FS1326-T

Carbon Monoxide Alarm
Wireless interlink



FA3820-EUX10

Carbon Monoxide Alarm
Low level CO monitoring



FA3328-EUT

Carbon Monoxide Alarm
Sync-It™ (NFC technology)



FA3322-EUX10

Carbon Monoxide Alarm
Digital display

MAINS WITH 9V BACK-UP BATTERY:



CW1-PF-T

Carbon Monoxide Alarm
9V Replaceable Battery Back-up



FA3313-EUX10

Carbon Monoxide Alarm
1 Year Replaceable AA Batteries

REPLACEABLE BATTERY:



CONNECT THE RANGE: WIRELESS

Compatible with FireAngel Specification products for wireless interlink.

Also works with our Connected Home Solution, designed to allow social housing providers to offer residents with maximum fire and CO protection.



FS1326-T (Sealed Battery)
Carbon Monoxide Alarm
Wireless interlink



CO AND ENVIRONMENTAL SENSING



FA3328-EUT (Sealed Battery)
Carbon Monoxide Alarm
Sync-It™ (NFC technology)



FA3322-EUX10 (Sealed Battery)
Carbon Monoxide Alarm
Digital Display





Tried and trusted products

Our alarms are calibrated and tested in carbon monoxide gas and meet BSI Kitemark certification



BS 50292:2023 recommends:

CO alarms are installed in any room with a fuel burning appliance e.g. kitchen, living/dining room, bedroom



Advanced CO sensing

An accurate and proven method of sensing carbon monoxide ensuring CO safety at all times



Earliest CO warning

Designed to accurately measure very low levels of CO to provide the earliest warning



FS1326-T

Specification Carbon Monoxide Alarm

10 Year Sealed Lithium Battery

[View online >](#)

- Advanced electrochemical sensor
- Unique diagnostic capability to provide a report giving the time, date and level of CO in the property
- Fit a Smart RF Module for wireless compatibility
- EN 50291-1:2018 & EN 50291-2:2019
- Works with all Specification devices including our Connected Home Solution



FA3820-EUX10

Carbon Monoxide Alarm

10 Year Sealed Lithium Battery

[View online >](#)

- Advanced electrochemical sensor for rapid CO detection
- BS EN 50291-1: 2018 & BS EN 50291-2: 2019
- Low level monitoring with unique 'pre alarm' and ventilate warning
- Memory function indicates previous alarm activation
- Advanced diagnostics support via cable (sold separately)



CW1-PF-T

Carbon Monoxide Alarm

Mains Powered with Replaceable 9V Battery Back-up

[View online >](#)

- Electrochemical sensor for CO detection
- EN 50291-1: 2018
- Supplied with push fit base
- Interconnect multiple devices: hardwire interlink up to 12 devices with compatible alarms
- Works with SW1-PF-T (smoke) and HW1-PF-T (heat)



FA3313-EUX10

Carbon Monoxide Alarm

1 Year Replaceable Batteries

[View online >](#)

- Electrochemical sensor for CO detection
- 10 year alarm life
- BS EN 50291-1: 2018 & BS EN 50291-2: 2019
- Replaceable batteries: supplied with 2 x AA batteries





Tried and trusted products

Our alarms are calibrated and tested in carbon monoxide (CO) gas and meet BSI Kitemark certification



BS 50292:2023 recommends:

CO alarms are installed in any room with a fuel burning appliance e.g. kitchen, living/dining room, bedroom



FA3328-EUT

Sync-It™ (NFC technology)
Carbon Monoxide Alarm

10 Year Lifetime Sealed Battery

[View online >](#)

- Low level CO monitoring and advanced electrochemical sensor for rapid CO detection
- Environmental insights to record temperature and humidity levels
- BS EN 50291-1: 2018 & BS EN 50291-2: 2019
- Easy wireless data extraction via Sync-It™ (NFC technology)
- Data download via smartphone includes CO ppm / temperature and humidity via FireAngel free app



FA3322-EUX10

Digital Display Carbon Monoxide Alarm
10 Year Lifetime Sealed Battery

[View online >](#)

- Low level CO monitoring and advanced electrochemical sensor for rapid CO detection
- Environmental insights to record temperature and humidity levels
- BS EN 50291-1: 2018, BS EN 50291-2: 2019
- Multi-function digital display: visual user instructions with LCD colour variations depending on event type
- Advanced diagnostics via cable (sold separately)



FA3328-EUT

Sync-It™ (NFC technology)
Carbon Monoxide Alarm



Diagnostics Report
[Free Installer App](#)



Environmental Range

FireAngel offers both semi-connected technology and smart IoT solutions that monitor an environment within a property including temperature and humidity levels. These environmental insights are the two principle indicators to help proactively identify potential damp and mould problems or can prevent future problems from arising.



RANGE ECOSYSTEM: ENVIRONMENTAL



FA3328-EUT (Sealed Battery)
Temperature & Humidity Sensing
Carbon Monoxide Alarm



FA3322-EUX10 (Sealed Battery)
Digital Display
Carbon Monoxide Alarm



FS2550W2ZB-T (Mains)
Home Environment Gateway



DIGITAL DISPLAY:



FA3322-EUX10 (Sealed Battery)
Digital Display
Carbon Monoxide Alarm

With a multi-functional LCD digital display, tenants can experience both audible and visual safety warnings with dangerous temperature and humidity conditions highlighted to encourage intervention.



APP ENABLED:



FA3328-EUT (Sealed Battery)
Temperature & Humidity Sensing
Carbon Monoxide Alarm

Built-in temperature and humidity sensors log readings in properties, which when using the free Installer App and Sync-It™ (NFC technology), allows advanced diagnostics to be easily extracted with multiple shareable report options.



MAINS POWERED GATEWAY:



FS2550W2ZB-T (Mains)
Home Environment Gateway

FireAngel's Home Environment Gateway delivers a holistic resident safety solution, encompassing fire safety, AI-driven risk analysis and background environmental monitoring with temperature and humidity sensors incorporated.





Environmental insights

Such as temperature and humidity levels – the two principle indicators for damp and mould



Suitable for all homes

Standalone and mains options to suit immediate or long-term implementation



Battery and mains options

Supporting social and private landlords to implement immediate changes



Damp and mould prevention

Enabling housing providers to prioritise damp and mould interventions and enhance prevention



FA3328-EUT

Temperature and Humidity Sensing with Carbon Monoxide Alarm

10 Year Lifetime Sealed Battery

[View online >](#)

- Environmental sensing with temperature and humidity levels recorded with the ability to extract into shareable reports through Sync-It™ (NFC technology)
- Using FireAngel's free app, Sync-It™ (NFC technology) allows advanced diagnostics to be easily extracted with multiple report options
- BS EN 50291-1: 2018, BS EN 50291-2: 2019



FA3322-EUX10

Digital Display Carbon Monoxide Alarm

10 Year Lifetime Sealed Battery

[View online >](#)

- Multi-function digital display: visual user instructions with LCD colour variations depending on event type
- Low level CO monitoring and advanced electrochemical sensor for rapid CO detection
- Environmental insights to record temperature and humidity levels
- BS EN 50291-1: 2018, BS EN 50291-2: 2019
- Advanced diagnostics via cable (sold separately)



FS2550W2ZB-T

Home Environment Gateway

Mains Powered with Rechargeable Battery Back-up

[View online >](#)

- Enables social housing providers to prioritise condensation, damp and mould interventions and increase fire prevention measures
- Features patented Predict® technology and in-built temperature and humidity sensors with automatic reporting to FireAngel's Connected cloud platform
- Can occupy the same footprint (use as the base plate) for one FireAngel Specification mains powered alarm, so no additional wiring is required
- Connects wirelessly via Smart RF to chosen network of devices and continually monitors alarms, creates a link between FireAngel Specification, Zigbee devices and FireAngel's Connected cloud platform
- Equipped with LTE/GPRS Cellular and Wi-Fi connectivity options
- For use in any room within a home (except bathroom and kitchens)

The Home Environment Gateway provides a holistic resident safety solution, encompassing fire safety, AI-driven risk analysis and environmental monitoring to ensure compliance and proactive maintenance in properties.

[Explore how Home Environment Gateway addresses UK housing requirements >](#)



Accessories Range

FireAngel are committed to developing technologies that ensure the highest level of fire and CO detection to protect all communities. Our additional accessories allow housing providers to quickly enhance protection and can be tailored to specific requirements or third-party integrations.

RANGE ECOSYSTEM: ACCESSORIES

We offer a range of additional accessories that are compatible with our core safety devices. Allowing both social and private housing providers to cost-effectively fit additional safety devices to enhance protection.



EXS230-1
External Sounder



RF-BW-T
RF Interlink base



FS1521W2-T
Smart RF Module



FS1524W2-T
Wireless Alarm Control Unit



RLYM-1EU
Mains Relay



WRLYM-1EU
Wireless Mains Relay



FS1552W2-T
Strobe and Vibrating Pad



INTERLINK THE RANGE: VIA WIRELESS MODULE



FS1521W2-T
Smart RF Module

To enable wireless interlink for multiple Specification devices, simply add the Smart RF Module during installation or in the future.

Watch video on
how to 'learn in'





Ultimate protection

Our products feature innovative technologies and comply to the latest legislative requirements



Trusted nationally

We have worked closely with UK fire and rescue services and UK housing to develop enhanced safety solutions



Additional accessories

Offering additional solutions to social housing and private landlords for enhanced protection



Easy installation

Quick and easy solutions that can enhance fire and CO protection for high-risk individuals



EXS230-1
Weatherproof External Sounder
Mains Powered

[View online >](#)

- Install alongside the Mains Powered Relay (RLYM-1EU) enabling connectivity into the Specification network of protection
- Low current consumption and high SPL in a robust fire retardant housing
- Suitable for all general signalling applications including fire, security and process control with 100dB(A) output



RF-BW-T
RF Interlink Push Fit Base
10 Year Lithium Battery

[View online >](#)

- Base enables wireless interlink between multiple SW1-PF-T, HW1-PF-T and CW1-PF-T alarms
- Quick to install and easy to link, ideal when refurbishing or extending an existing property
- RF transmitter and receiver in each base unit for high performance

Please note, RF-BW-T will not interlink to Specification Smart RF products





Create a network with Smart RF

Fit a Smart RF Radio Module for wireless compatibility to interlink multiple alarms



Ultimate protection

Our products feature innovative technologies and comply to the latest legislative requirements



Additional accessories

Offering additional solutions to social housing and private landlords for enhanced protection



Easy Installation

Quick and easy solutions that can enhance fire and CO protection for high-risk individuals



FS1521W2-T
Specification Smart RF Module
10 Year Lithium Battery

[View online >](#)

- Works with all Specification devices
- Fit this Smart RF Module within Smart RF Ready devices to wireless interlink multiple devices on a single network, including a FireAngel Connected Gateway
- Quick and easy installation - simple to place into alarm
- RF transmitter and receiver in each module for high performance



FS1524W2-T
Specification Wireless Alarm Control Unit
10 Year Sealed Battery

[View online >](#)

- Features Smart RF wireless technology and works with all Specification devices including our Connected Home Solution
- Easily test, silence and locate Smart RF enabled wireless alarms
- Memory function flashes if alarm has activated
- Suitable to assist the elderly, disabled or residents in properties with high ceilings



RLYM-1EU
Specification Relay - Hardwired
Mains Powered with Battery Back-up

[View online >](#)

- Connect fire and CO alarms to external devices such as fire doors and other Telecare systems
- Ultra slim design with “pulse signal” or a “continuous switched signal” options
- Hardwire interlink to a mains powered Specification smoke (SM-SN-1) or heat alarm (HM-SN-1)
- Wireless only relay also available (WRLYM-1EU)



FS1552W2-T
Specification Combined Strobe and Pad
Mains Powered with Rechargeable Battery Back-up

[View online >](#)

- Features Smart RF wireless technology and works with all Specification devices including our Connected Home Solution
- Designed to provide an alert to those with hearing loss, who may not hear an audible alarm
- Flashing strobe provides visual warning for waking hours, while vibrating pad can be placed under a pillow or mattress

Standards and Regulations

Ensuring you are up-to-date with all the latest industry standards and regulations is **vital to ensure you remain compliant.**

We provide housing and trade professionals with all the latest information including recent and upcoming changes, highlighting how to comply, covering legislation and standards relevant to cold, damp & mould, carbon monoxide (CO) and fire safety in the UK.

Understand the smoke, heat and carbon monoxide alarm regulations required for properties in the UK to ensure you stay up-to-date and ensure compliance.

 [England >](#)

 [Wales >](#)

 [Scotland >](#)

 [Northern Ireland >](#)



[View all Standards and Regulations >](#)

BS 5839-6 British Standards

Fire safety is one of the key sections within the Building Regulations, which outlines the requirements needed to provide an early warning of fire, escape routes, preventing the spread of fire, and providing access to fire fighting facilities for the Fire and Rescue Services.

UK Fire Building Regulations point towards BS 5839 as the key code of practice for the planning, design, installation, commissioning and maintenance of fire detection.

BS 5839-6:2019 | Table 3*- Testing and servicing by grade

In conjunction with changes to Table 1, a new Table 3 has also been introduced, which outlines the recommended testing and servicing by grade per grade of detection.

Grade of detection	Type of fire detection & fire alarm system	Frequency of test by user	Testing action to be taken by user
A	Systems of a type described in BS 5839-1:2017	Weekly	As in BS 5839-1:2017
C	Fire detectors and fire alarms supplied with power from a common PSU, with central control equipment	Monthly	Press test button on central control equipment (if a fire alarm system has no test button, testing should be carried out in accordance with the manufacturer's or supplier's instructions, or advice should be sought from a service company)
D	Mains-powered smoke alarms, heat alarms or multi-sensor alarms with standby supplies	Monthly	Press test button
F	Battery-powered smoke alarms, heat alarms or multi-sensor alarms	Monthly	Press test button

*For further advice please refer to the BS 5839:6-2019 standard

Maintaining and testing alarms

Best practice advises cleaning and regularly testing your smoke alarms. This is the best way to ensure alarms perform for longer and allows for any issues within the unit to be identified quickly.

[Learn more >](#)



75



BS 5839-6:2019 | Revised Table 1*

Updated Minimum Standards

To reflect current types of living conditions, latest revisions include new minimum grades and categories of systems split by new build or existing property.

Class of premises	Grade	Category	Further Notes to Consider
Rented	Grade D1	LD2	Note D: Heat detectors should be installed in every kitchen. A smoke detector should be installed in the principal habitable room(s).
New Build/Existing			
Sheltered Housing (Existing)	Individual Dwellings: Grade D2 Communal Area: Grade A	LD2	Note Q: Where sheltered housing is upgraded, electrical work such as a rewire is undertaken, or smoke alarms are replaced a Grade D (D1 or D2), Category LD1 system should be installed.
With Individual Dwellings and Communal Areas			
Sheltered Housing (New/Materially Altered)	Individual Units: Grade D2 Communal Area: Grade A Part 1 Recommendations	LD1	Note J: Detectors may normally be omitted from roof voids unless there are specific significant fire hazards such as gas boilers or electrical equipment for photovoltaic systems.
With Individual Dwellings and Communal Areas			
House of Multiple Occupancy (HMO)	Existing: Grade D1 New Build: Grade D1	LD2 LD1	Note D Note J Note N: If cooking facilities in room, install heat alarm.
Owner Occupied < 200m floor area	New (<3 Storey): Grade D2 New (<4 Storey): Grade A	LD2 LD2	Note D Note D



BS 5839-6:2019 | Revised Table 1 continued

New Minimum Standard for Rented Properties and Owner Occupied:

- **Rented Properties** - New Minimum Standard now requires LD2 and D1 Grade alarms whether existing or new build, plus note D
- **Owner Occupied** - New Minimum Standard now requires LD2 and D2 alarms plus note D for new builds / materially altered. Grade F2 alarms and LD3 min for bungalow / single storey unit but now with notes E), F) and G

Notes:

- **13.2c)** In all premises, all smoke alarms and heat alarms (if provided) in Grade D and Grade F systems should be interlinked, such that, when fire is detected by any smoke alarm or heat alarm, an audible fire alarm warning is given by all smoke alarms and heat alarms in the premises.

Owner occupied properties:

- **Note E)** A Grade F1 system should be installed if there is any doubt regarding the long term suitability or reliability of a battery powered system, i.e. the ability to replace batteries
- **Note F)** Where electrical work such as a rewire is undertaken, Grade D1 or D2 category LD2 system should be installed
- **Note G)** Scottish Housing Act 1987 Order 2019 (11), Grade F1, Category LD2 systems are a minimum in existing dwellings

We offer free training on latest standards and regulations

Our field support team offer bespoke group training sessions on BS 5839-6:2019. These can be arranged to accommodate your installer/contractors, maintenance teams or internal staff and can be hosted in the comfort of our offices or on-site at your convenience.

 [Get in touch today to arrange a session >](#)



BS 5839-6:2019 | Revised System Grading

In the latest revision, the previously defined six system grades have been revised by eliminating Grade B and Grade E. Additionally, Grade D and Grade F are now subdivided into Grade D1/Grade D2 and Grade F1/Grade F2, respectively.

System Grades - for fire detection and fire alarm systems as per BS 5839-6:2019

GRADE A

Separate detectors, sounders and central control and indicating equipment with back-up power supply that conforms to British Standards BS EN 54.

GRADE C

A system of fire detectors and alarm sounders (which may be combined in the form of smoke alarms) connected to a common power supply, comprising the normal mains and a standby supply, with central control equipment.

GRADE D1

A system of one or more mains powered detectors, each with a tamper proof standby supply consisting of a battery or batteries (such as **SM-SN-1** and **HM-SN-1** alarms).

GRADE D2

A system of one or more mains-powered detectors, each with an integral standby supply consisting of a user replaceable battery or batteries (such as **SW1-PF-T** and **HW1-PF-T** alarm).

GRADE F1

A system of one or more battery-powered detectors powered by a tamper-proof primary battery or batteries (such as **FS2126-T**, **FS1226-T** and **ST-622T** alarms).

GRADE F2

A system of one or more battery-powered detectors powered by a user-replaceable primary battery or batteries (such as **SB1-T** alarm).

Mainly applied to standard UK housing

Please note: Grade B and E are no longer defined in updated BS 5839:6-2019

BS 5839-6:2019 | Categories

The three categories for fire detection and fire alarm systems are listed below - these outline where fire detection systems should be installed per category with additional recommendations to install heat alarms in kitchens.

LD1 MAXIMUM PROTECTION

Escape routes, high risk rooms plus all areas where a fire might start

The highest level of protection of all occupants who might occupy the dwelling over the lifetime of the fire detection and fire alarm system. A system installed throughout the premises, incorporating detectors in all circulation areas that form part of the escape routes from the premises, and in all rooms and areas, other than those with negligible sources of ignition, such as toilets, bathrooms and shower rooms.

Hallway, Landing, Living Room, Kitchen (Heat Alarm), Bedroom, Airing / Meter Cupboards, Loft, Garage

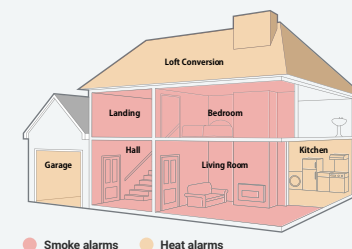

LD2 ADDITIONAL PROTECTION

Escape routes plus high risk rooms

A system incorporating detectors in all circulation areas that form part of the escape routes from the premises, and in all specified rooms or areas that present a high fire risk to occupants, including a heat alarm in any kitchen and a smoke alarm in principle habitable room(s).

Note: This is now the new minimum category for all rented properties and must include a heat alarm in the kitchen and a smoke alarm in principle habitable room(s).

Hallway, Landing, Living Room, Kitchen (Heat Alarm)

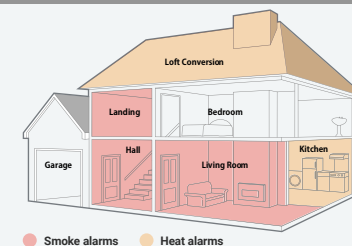

LD3 MINIMUM PROTECTION

Escape routes only

A system incorporating detectors in all circulation areas that form part of the escape routes from the premises. Smoke alarms should be installed in all circulation spaces that form part of escape routes such as:

Note: This minimum category now only applies to owner occupied bungalow, flat, single-storey unit or maisonette with no floor level above 4.5m from ground level or owner-occupied two-storey house.

Hallway, Landing

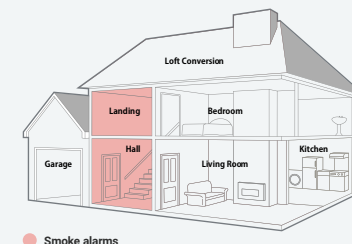

2018 Revision to EN 50291-1

The European standard on carbon monoxide
(CO) detection in domestic buildings

On 26th September 2021, BSI withdrew the European Standard EN 50291-1:2010 for carbon monoxide and introduced a revised version, EN 50291-1:2018, as a replacement.

All carbon monoxide alarms manufactured after 26th September 2021, must undergo testing and adhere to the updated EN 50291-1:2018 standard for compliance.

What do professionals need to know about the new changes to the EU Standard?



End of life indicator is mandatory

All products complying to the new standard will carry an end of life indicator – already a standard feature on FireAngel CO alarms.



Increased alarm sound output

In line with the EN 14604:2005+AC:2008 Standard, the sound output has been increased for a louder alarm and improved user safety.



Standardised rules on alarm silence facility

Tests have been added for an optional alarm silence facility to increase user safety by not allowing the alarm to be silenced at concentrations of over 300ppm.



Increase in potential interference gases

The number increase creates a better resistance to nuisance alarms and ensures the sensor will recover from limited exposure to react to CO afterwards.



Clarification on audible and red visual signals

All alarms are supplied with a minimum of 3 LEDs and an informative annex to indicate visual warnings and identify audible low battery, fault and end of life alerts.



Informative annex for low CO levels

A new annex has been added for alarms displaying the warning for low CO levels, now providing recommendations regarding how these displays might perform.

Referencing: Alarm Placement

Building regulations vary throughout the UK, and so specifying the correct level of safety and ensuring accurate installation is crucial to resident safety within properties.

BEST PRACTICE SUGGESTS THAT:

- Ceiling-mount smoke alarms centrally and within 7.5m of the farthest wall, a door to potential fire rooms, and the next smoke alarm.*
- Ceiling-mount heat alarms centrally and within 5.3m of the farthest wall, a door to potential fire rooms, and the next heat or smoke alarm.*
- Install CO alarms 1m–3m from potential CO sources (fuel-burning appliances).*
- All smoke, heat and CO should be sited at least 300mm from walls and light fittings.

** Install alarms following current standards and regulations.*

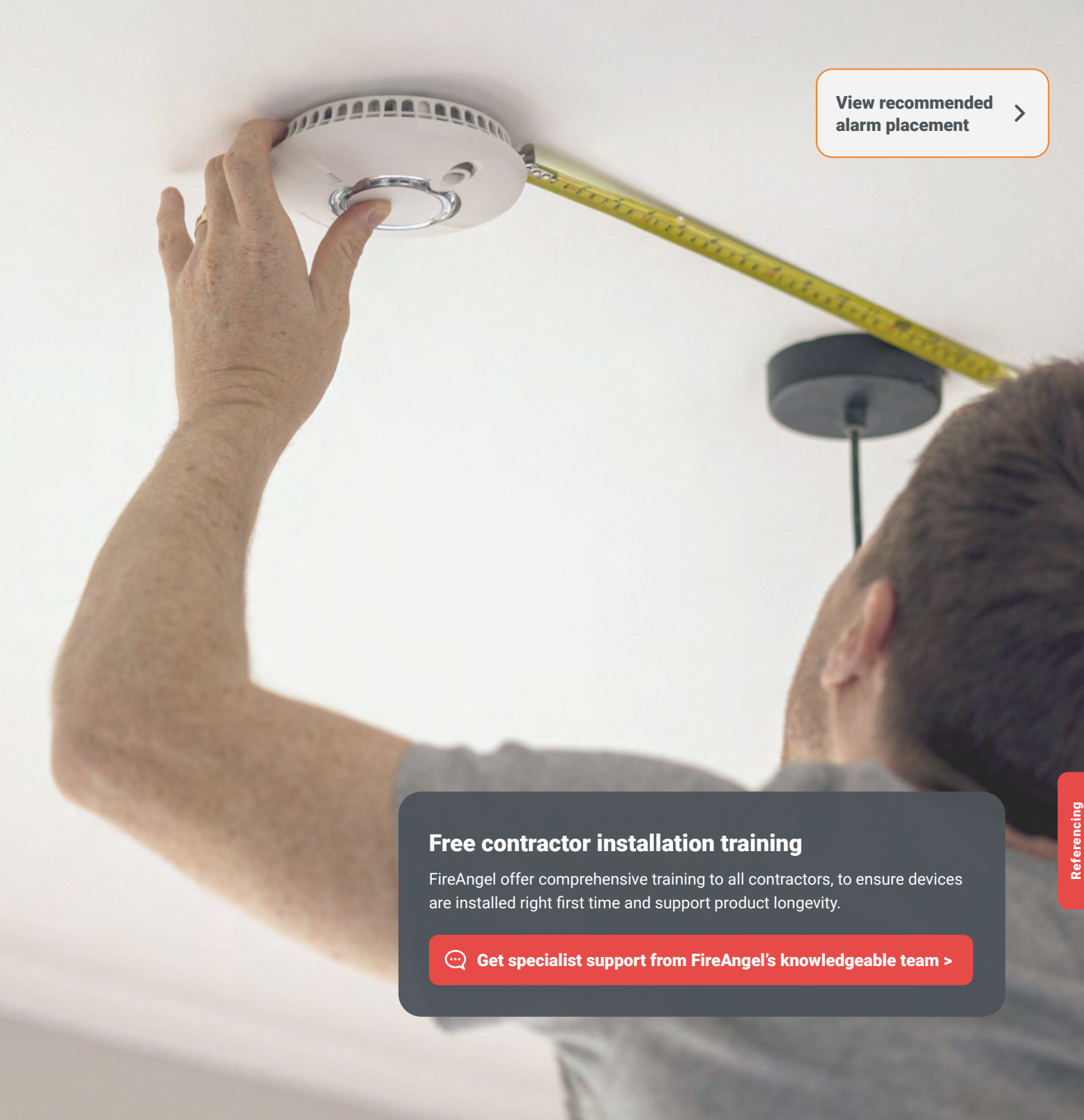

[View recommended alarm placement >](#)

Free contractor installation training

FireAngel offer comprehensive training to all contractors, to ensure devices are installed right first time and support product longevity.

[Get specialist support from FireAngel's knowledgeable team >](#)

Training and Expertise

Available to Trade customers, our free installer training offers professionals the opportunity to gain expert knowledge for best practice.

TRAINING AVAILABLE TO PROFESSIONALS:

Product installation

Our field experts offer comprehensive product training to support best practice and ensure safe and correct installation.

Arrange a session >



Standards and regulations

We offer bespoke group training sessions covering the latest fire and CO standards.

Arrange a session >



We're here to help - get in touch today:



fireangel.co.uk/pro



sales@fireangeltech.com



02477 717 700

FireAngel®

Fire ◻ Carbon Monoxide ◻ Environmental



fireangel.co.uk



[@fireangeltech](https://www.linkedin.com/company/fireangeltech)



[@FireAngelSafetyTechnology](https://www.youtube.com/channel/UCv8v8v8v8v8v8v8v8v8v8v8)

FireAngel Safety Technology Group PLC

Vanguard Centre, Sir William Lyons Road, Coventry, CV4 7EZ